

G-49

06-23-(174)-021-000-012
06-24-174-000-018

06-23-021-000-012
11 174
06-24-174-000

#12129

APPROVED	
LORAIN CO.	
MAP DEPT.	
DATE 10-6-78	
PAGE 6-49	
BY	<i>Bohler</i>
VOID	
AFTER	

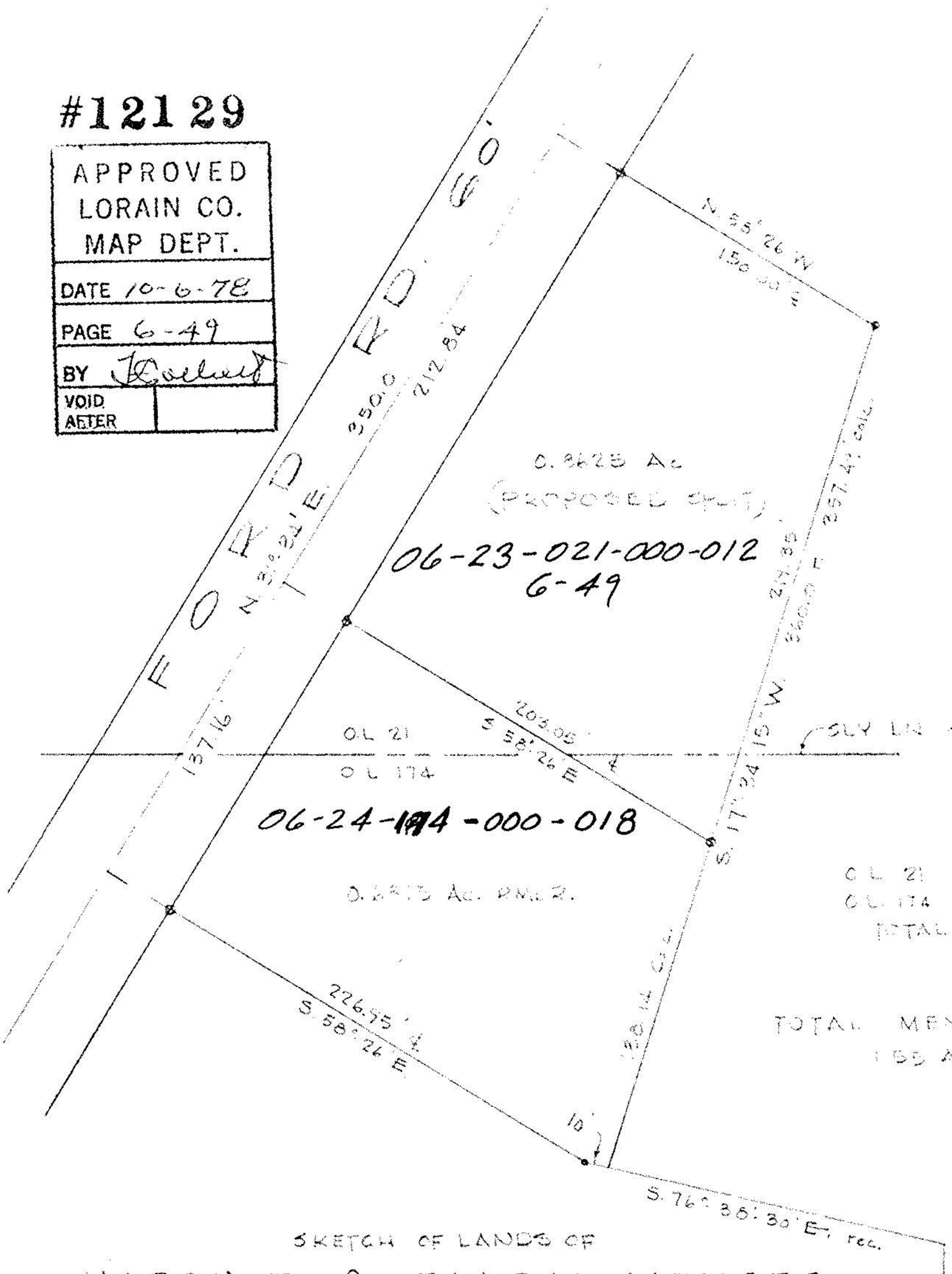

0.8625 Ac
(PROPOSED SPLIT)
06-23-021-000-012
6-49

06-24-174-000-018
0.8625 Ac. P.M. 2.

OL 21 0.8337 Ac
OL 174 0.0288 Ac
TOTAL SPLIT 0.8625 Ac.

TOTAL MENCS PROP
1.55 Ac RECORD

SKETCH OF LANDS OF

HARRY T. & ELLEN MENGES

OL 21 BRACE TR OL 174 WEST OF RIVER
TOWNSHIP and CITY OF ELYRIA LORAIN CO. OHIO
SCALE 1"=60' JULY, 1978
LAUNDON • SIMON • CAHL & ASSOC.
ENGINEERS SURVEYORS