

MARGARET A. UPHAM ET AL D.V. 405 P. 38

S/L 116 S/L 115 S/L 114
S/L 167 S/L 168 S/L 169

-010

No Hook
ON TAX
MAP

-029

S-90°00'00"-E
± 96' Rec.

96.00 Meas.

N-90°00'-E
24.00'

ELYRIA DEVELOPMENT LIMITED PARTNERSHIP

O.R.V. 402 P. 567

S-0°04'00"-W
15.55 M.
15.55 R.

0.0086 A.
372.945-F.T.

15.52'
S-0°00'-E
I.P. Set

ELYRIA DEVELOPMENT LIMITED PARTNERSHIP

O.R.V. 264
(PCL. No 1)

P. 865
(PCL. No 2)

SPITZER HARDWARE & SUPPLY CO. D.V. 735 P. 354
41.91' Rec.

19578
06-26-062-000-
EAST AVENUE 66' Z

183' Rec.
184.90± Rec.
18' R.
I.P. Fd.
147.00' Rec. & Used
55' Rec. & M.
I.P. Fd.

N-0°00'00"-E
92' Rec.

86' Rec.
70' Rec.

165' R.

16' Rec.

165' R.

66' Rec.
70' Rec.
N-89°45'00"-W

42' Rec.
50' Rec. & M.
120.00'

SECOND STREET 66'

(A.K.A. "GRACE COURT")

SCALE: 1" = 20'

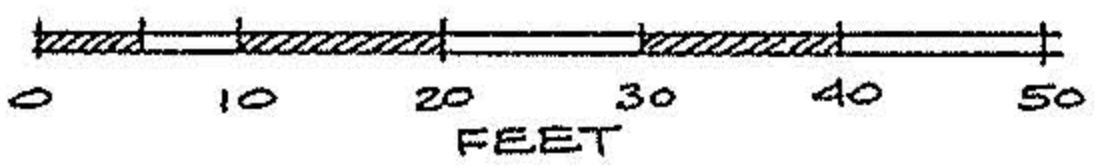

BOUNDARY SURVEY

PART OF SUBLOTS 168 & 169 IN BLOCK 62
HEMAN ELY'S TOWN PLAT OF ELYRIA - P.V. 3 P. 14

CITY OF ELYRIA COUNTY OF LORAIN STATE OF OHIO

David L. Elwell
REG. SURV. No. 6333

PREPARED BY

19578

KS ASSOCIATES INC APPROVED
ENGINEERS SURVEYORS

DATE	9-27-91
PAGE	6-120
BY	CAROLYN FRANCIS #253-A
VOID AFTER	# 19578

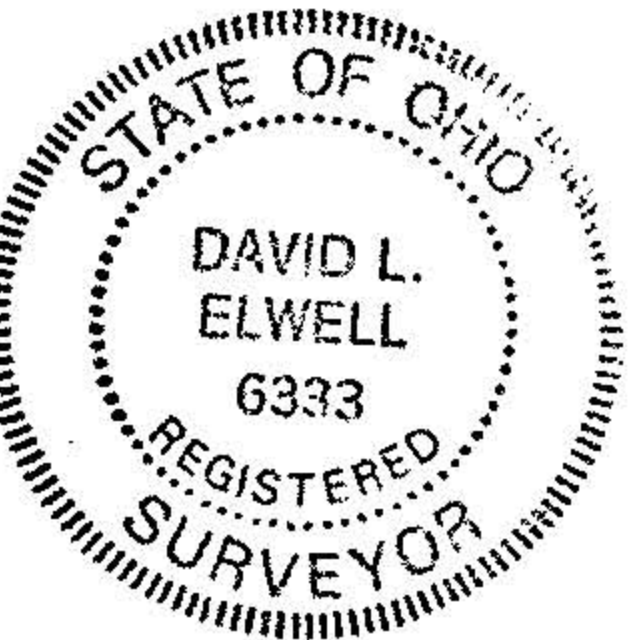

6-120