

06-25-032-102

GULF ROAD

HILLIARD ROAD

VALLEY BLVD.

SPRING VALLEY SUB. NO. 2

P.V. 12 PG. 22

141 140 139 138 137 136 135 134 133 132 131 130 129 128

125' 40' 40' 50' 45' 842.55' 512.55'

1. 330.00' 0.7528 AC. 512.21'

2. 330.00' 292.55' 0.7576 AC. 550.00' S-87°21'20"-E

3. 292.55' 0.5372 AC. 390.00' 160.00'

4. 292.55' 0.7576 AC. 550.00' S-87°21'20"-E

5. 292.55' 0.7576 AC. 550.00' S-87°21'20"-E

6. 292.55' 0.7576 AC. 550.00' S-87°21'20"-E

7. 292.55' 0.7576 AC. 550.00' S-87°21'20"-E

8. 292.55' 0.7576 AC. 550.00' S-87°21'20"-E

9. 292.55' 0.7576 AC. 550.00' S-87°21'20"-E

10. 292.55' 0.7576 AC. 550.00' S-87°21'20"-E

11. 292.55' 0.7576 AC. 550.00' S-87°21'20"-E

12. 292.55' 0.7576 AC. 550.00' S-87°21'20"-E

13. 292.55' 0.7576 AC. 550.00' S-87°21'20"-E

14. 292.55' 0.7576 AC. 550.00' S-87°21'20"-E

15. 292.55' 0.7576 AC. 550.00' S-87°21'20"-E

16. 292.55' 0.7576 AC. 550.00' S-87°21'20"-E

17. 292.55' 0.7576 AC. 550.00' S-87°21'20"-E

18. 292.55' 0.7576 AC. 550.00' S-87°21'20"-E

19. 292.55' 0.7576 AC. 550.00' S-87°21'20"-E

20. 292.55' 0.7576 AC. 550.00' S-87°21'20"-E

21. 292.55' 0.7576 AC. 550.00' S-87°21'20"-E

22. 292.55' 0.7576 AC. 550.00' S-87°21'20"-E

23. 292.55' 0.7576 AC. 550.00' S-87°21'20"-E

24. 292.55' 0.7576 AC. 550.00' S-87°21'20"-E

25. 292.55' 0.7576 AC. 550.00' S-87°21'20"-E

26. 292.55' 0.7576 AC. 550.00' S-87°21'20"-E

NOTE: THIS SURVEY MAP BASED ON SURVEY BY J.W. WARDEN PLATTED & DATED OCT. 11, 1939. NO PINS HAVE BEEN SET.

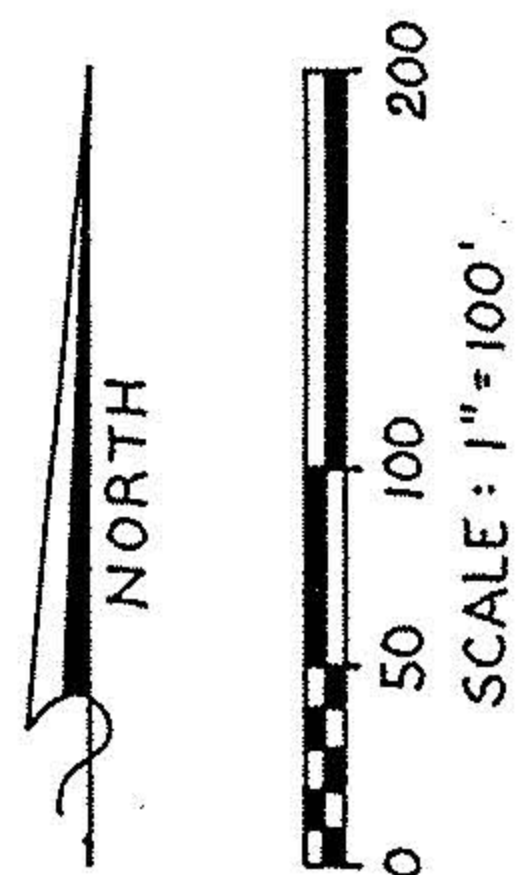

06-25-032-102-022

SURVEY MAP

OF PARTS OF SUBLOTS NOS. 1, 2, 3 & 4

IN CRESTVIEW ALLOTMENT · P.V. 13 PG. 28

CITY OF ELYRIA · COUNTY OF LORAIN · STATE OF OHIO

PREPARED BY:
KS ASSOCIATES, INC.
424 Middle Ave. P.O. Box 89
ELYRIA, OHIO 44036
(216) 322-6317

David L. Elwell
DAVID L. ELWELL REG. SURV. NO. 6333

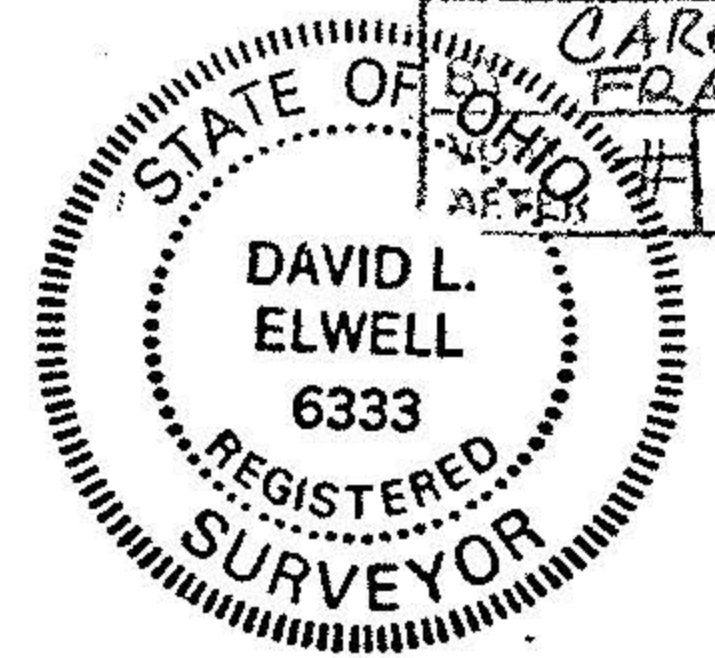

#19462

APPROVED
LORAIN CO.
MAP DEPT.
DATE 7-8-91
PAGE 6-68
CAROLYN FRANCIS
#19462

SPRING VALLEY SUB. NO. 8
P.V. 18 PG. 28

CORONADO COURT