



# KLEINOEDER-SCHMIDT

and ASSOCIATES

ENGINEERS — SURVEYORS — CONSULTANTS in LAND PLANNING

ELYRIA - NORWALK - MEDINA

OHIO

# SURVEY

Sublot(s) \_\_\_\_\_  
Subd'n \_\_\_\_\_

Township ELYRIA Tract EAST OF BLACK RIVER  
Orig. Lot(s) 7 Sec. \_\_\_\_\_  
County of LORAIN State of Ohio  
Corporation CITY OF ELYRIA

06-25-007-000-190

19657

DALE YOST  
d.b.a.  
D.B.L. CO.  
D.V. 1382  
P. 145  
  
(-172)  
2.05 AC.

**19657**

APPROVED  
LORAIN CO.  
MAP DEPT.

DATE	11-14-91
PAGE	76-125
BY	CAROLYN FRANCIS
VOID AFTER	19657

0.911 AC.  
(0.617 AC. REM.)

DALE YOST  
d.b.a.  
D.B.L. Co.  
D.V. 1382 P. 149

135.90' ±  
S-79°21'33"E

E. BROAD ST.  
(SUGAR RIDGE RD.)

ABBE ROAD ± 525.96'  
S-0°15'47"W

153.26'  
N-10°39'36"E

EXISTING SHOPPING CENTER BUILDING

N-11°02'53"E  
140.88'  
± 8" WALL

(0.294 ACRE)

S-78°57'07"E  
75.33'

268.17'  
R/W

151.45'  
N-0°52'37"E

S-0°52'37"W



OHIO ROUTE

(REDCO ASSOC.)  
D.V. 995 P. 716

N-0°20'07"E  
(FORMER #)

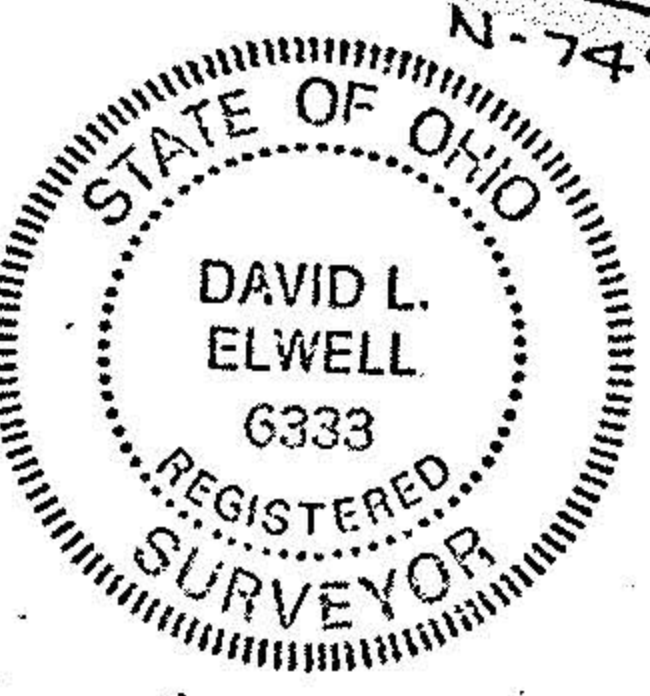

DOUG & NANCY GERBER  
(-179)  
O.R.V. 296 P. 95  
1.60 AC.

David L. Elwell REG. SURV. NO. 6333

Prepared for: DALE YOST

REVISED 10-7-91 BY  
KS ASSOCIATES INC.  
ENGINEERS SURVEYORS

Scale: 1" = 30'

Date: 1-17-86

Dr. by: D.E.

Job No 81-110