

STATE ROUTE 57 B.Y. PASS

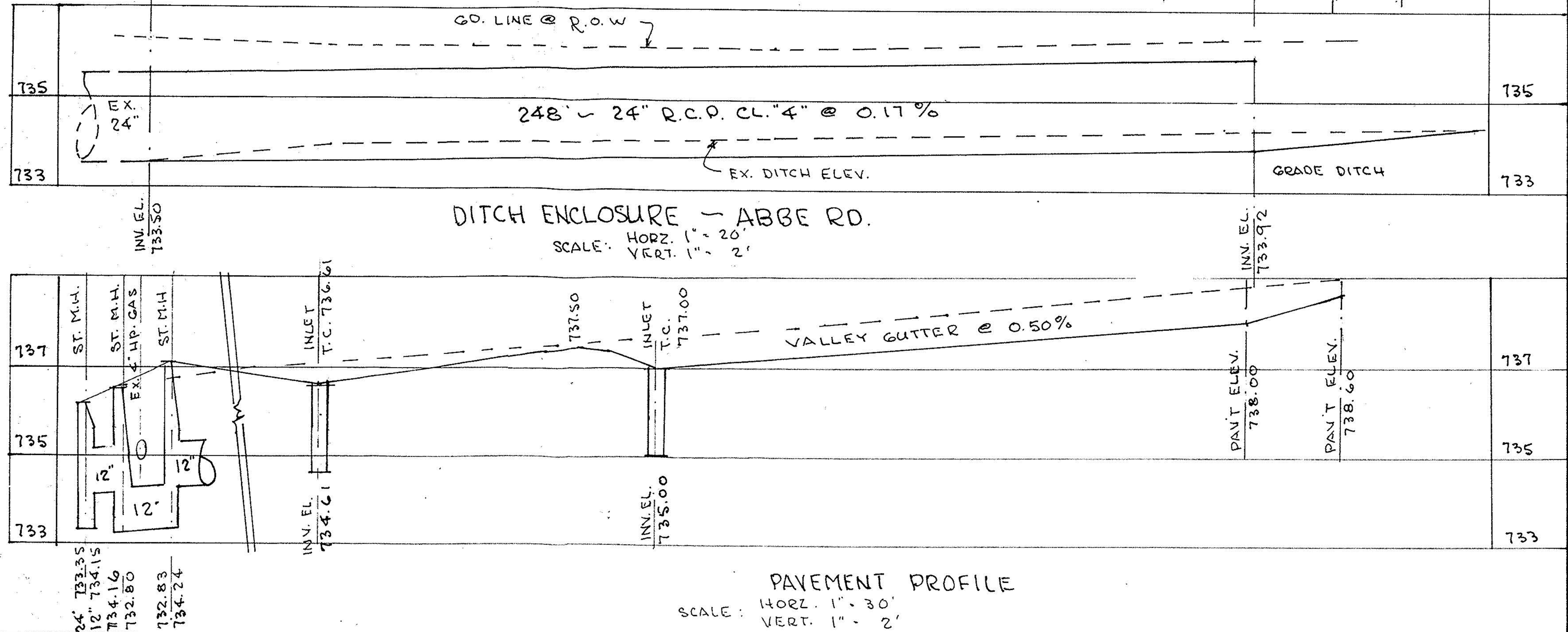

#16817  
APPROVED  
LORAIN CO.  
MAP DEPT.  
DATE 8-22-85  
BY T. M. [Signature]

TOPOGRAPHICAL SURVEY  
PART OF ELYRIA TOWNSHIP ORIGINAL LOT No 7 - E. OF R.  
CITY OF ELYRIA COUNTY OF LORAIN STATE OF OHIO  
SCALE: 1" = 30'  
PREPARED BY  
KLEINODER - SCHMIDT & ASSOC.  
CONSULTING ENGINEERS & SURVEYORS  
MAY 31, 1984

06-25-007-000 #16817 7.25  
06-25-007-000 #16817 7.25  
06-25-007-000 #16817 7.25