



KLEINOEDER-SCHMIDT

and ASSOCIATES

ENGINEERS — SURVEYORS — CONSULTANTS IN LAND PLANNING

ELYRIA - NORWALK - MEDINA

OHIO

SURVEY

Sublot(s) _____

Subd'n _____

Township ELYRIA

Tract EAST OF BLACK RIVER

Orig. Lot(s) 7

Sec. _____

County of LORAIN

State of Ohio

Corporation CITY OF ELYRIA

#22429

APPROVED
LORAIN CO.

MAP DEPT

DATE 2/10/98

PAGE 6-125

BY K. Colbert

DALE YOST
d.b.a.
D.B.L. CO.
D.V. 1382
P. 145

(-172)

2.05 AC.

DALE P. YOST & CATHERINE A. YOST, TRUSTEES
(DALE YOST D.V. 1382 P. 149)

NORTH

(0.600 AC. REM.)

0.617 AC.

(06-25-007-000-191)

E. BROAD ST.
(SUGAR RIDGE RD.)

ABBE ROAD &
S-0°15'47" W 525.96'

N-10°39'36" E 153.26'

EXISTING SHOPPING CENTER BUILDING

N-0°20'07" E 98.30'

N-11°02'53" E 140.88'

8" WALL

(0.3109 A. COMB.)

0.294 ACRE
(06-25-007-000-190)

DOUG GERBER JR. &
NANCY GERBER
O.R.V. 473 P. 544

DOUG & NANCY GERBER
(-179)
O.R.V. 296 P. 95
1.60 AC.

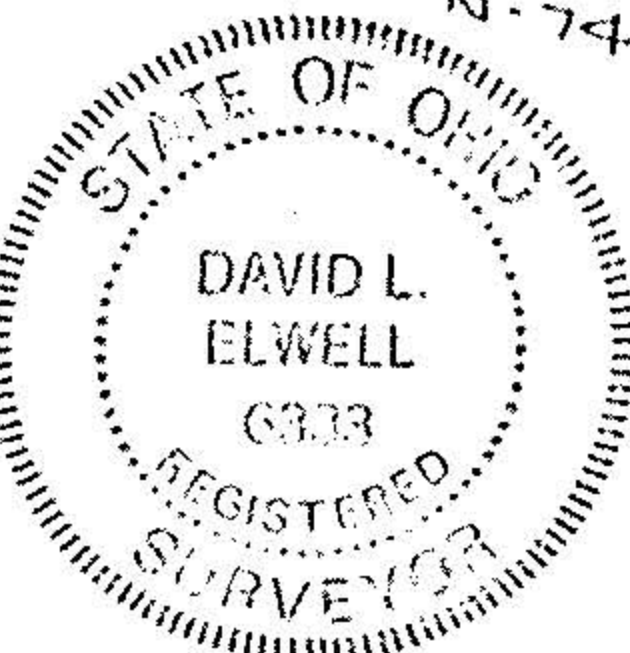

David L. Elwell REG. SURV. NO. 6333

Prepared for: DALE YOST

REVISED 10-7-91 BY
KS ASSOCIATES INC.
ENGINEERS SURVEYORS

REV. 1-5-98
(0.0169 AC.)

Scale: 1" = 30'

Date: 1-17-86

Dr. by: D.E.

Job No 81-110