

003 Melvin & Evelyn Pickens
DIV 1320 Pg 315

A 2916 sq ft 0.0669 Acre

- iron pipes fd
- iron

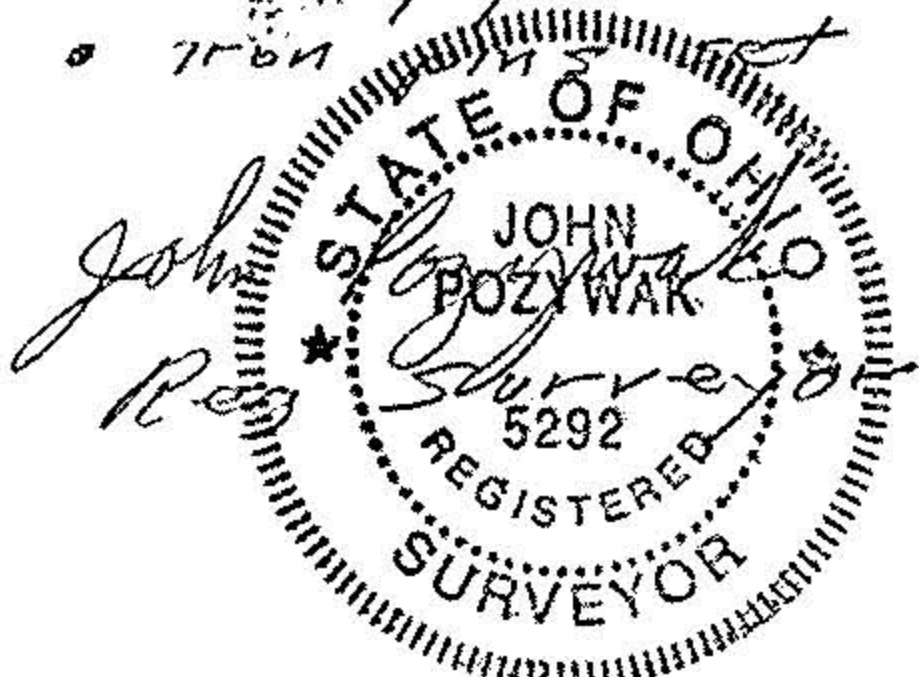

5292

Survey part of Sublot 2
 Nili Johnson Addition
 original Elyria Twp Lot 124
 West of the Black River
 City of Elyria
 Lorain County Ohio
 Scale 1"=40' Apr 3, 1997

22563

APPROVED
LORAIN CO.
MAP DEPT.
DATE
PAGE 6-100
BY JUST REFERENCE
VOID AFTER 22563

Donald J & Elaine J. Norris
 RR 5 1197
 OR 1128 Pg 311

Neuffer Ct