

TOTAL AREA = 21.47186 ACRES  
 TAKE AREA = 21.47186 ACRES  
 REMAINDER = 0.00000 ACRES

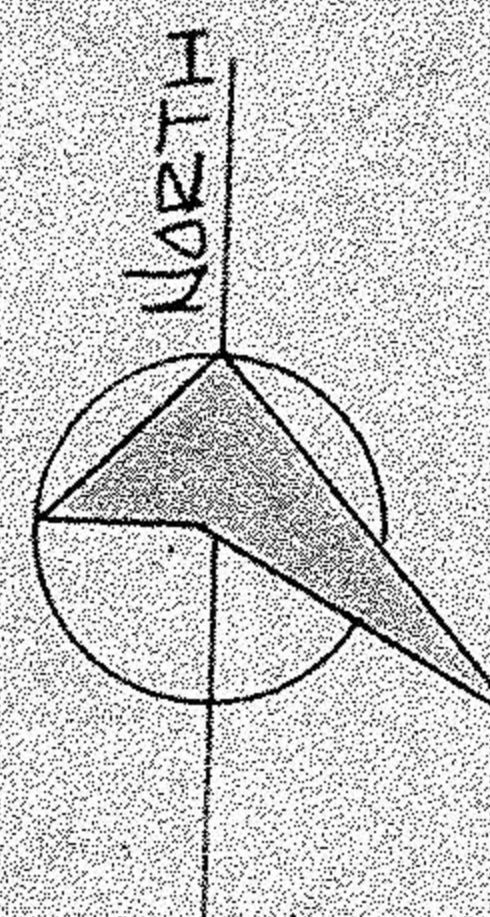

LORAIN COUNTY  
 METROPOLITAN PARK DISTRICT

JACK JOSEPH  
 VOL. 862 PGS 660, 661

6/5/16

R.R. SPIKE RD

Δ.L. 20 BRACE TRACT S 88° 56' 45" E  
 Δ.L. 21 BRACE TRACT

312.75' OBS  
 395.75' R S 80° 16' 00" E 83.00' ±

R.R. SPIKE RD  
 330.86' R S 59° 13' 45" E  
 321.80' OBS

S 66° 16' 00" E  
 64.65' OBS. 66.00' R

06-23-021-000-012

6-31

RIVER

LORAIN COUNTY  
 METROPOLITAN PARK DISTRICT  
 VOL. 952 PG. 683

AREA IN Δ.L. 20 = 0.18611 ACRES  
 AREA IN Δ.L. 21 = 21.28575 ACRES  
 TOTAL TAKE AREA = 21.47186 ACRES

JOHN TERRY - SPRING VALLEY ENT.  
 VOL. 689 PG. 640, 641

BLACK RIVER

ELLEN MENGES  
 VOL. 937 PG. 563  
 294.50' OBS  
 150.00' N 58° 24' 45" W  
 300.00' OBS  
 187.83' N 17° 33' 51" E

Δ.L. 21 BRACE TRACT  
 Δ.L. 174 WEST OF RIVER  
 909.03' M  
 974.03' OBS. N 88° 33' 22" W

LORAIN COUNTY METROPOLITAN PARKS  
 LAND ACQUISITION SURVEY  
 JOHN TERRY - SPRING VALLEY  
 ELYRIA TOWNSHIP

SCHAFER, HURA & ASSOCIATES, INC.  
 ENGINEERS AND SURVEYORS  
 4370 OBERLIN AVE.  
 LORAIN, OHIO

NBR  
 57

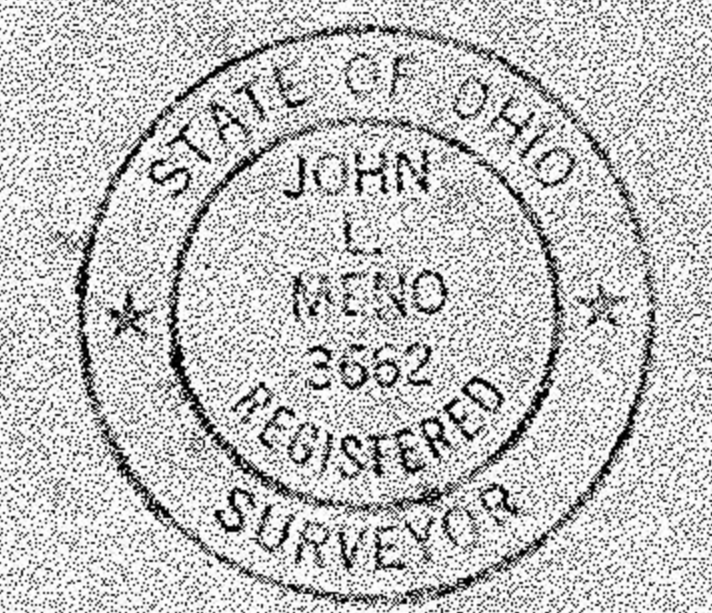

ORIGINAL LOT 20 & 21 BRACE DATE 1-30-  
 TOWNSHIP ELYRIA SCALE 1" = 100'  
 CITY OF FIELD BOOK 219 PGS 100-105  
 COUNTY OF LORAIN DRAWN BY JFR  
 STATE OF OHIO CHECKED BY J.L.M.  
 W. O. 1685-37 FILE NO. 6-BRACE-20,21