

#12129

APPROVED
LORAIN CO.
MAP DEPT.
DATE 10-6-78
PAGE 6-49
BY <i>J. Caldwell</i>
VOID
AFTER

6-49

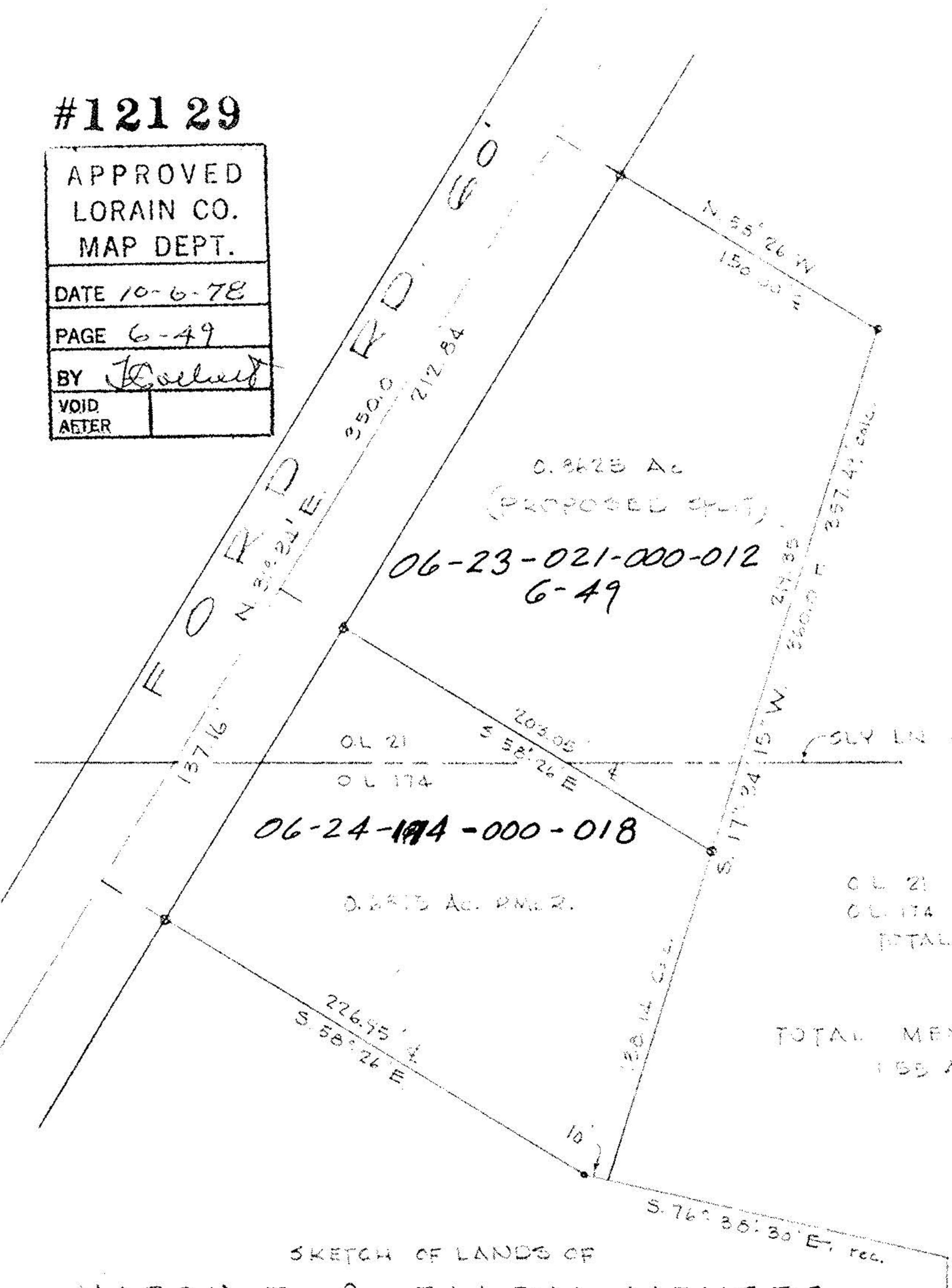

0.3623 Ac
 (PROPOSED SPIT)
 06-23-021-000-012
 6-49

06-24-174-000-018

OL 21 0.3237 Ac
 OL 174 0.2428 Ac
 TOTAL SPIT 0.5623 Ac

TOTAL MENCS PROP
 1.55 Ac RECORD

SKETCH OF LANDS OF

HARRY T. & ELLEN MENGES

O.L. 21 BRACE TR O.L. 174 WEST OF RIVER
 TOWNSHIP and CITY OF ELYRIA LORAIN CO. OHIO
 SCALE 1"=60' JULY, 1978
 LAUNDON • SIMON • CAHL & ASSOC.
 ENGINEERS SURVEYORS

06-23-(174) 06-23-021-000-012
 6-49

06-24-174-000-018

-021-

20921