

06-23-027-101-

20260

6-27

Adam Subdivision

⑨ outdoor Graphics Inc

149.94'
155.55'
20' 53" AC

149.09
N 89° 46' E

25.03 Aurd Drive
25.03 N 89° 46' E

Robert P. Graham
752.23'
N 2° 12' E 596.68'

2.018 Acres
Outdoor Graphics Inc

596.83'
S 2° 31' W
west line of
A111T
Billy G & Glenna Morrow

Schaden's A111T
P. Vol 7 1919

20260

APPROVED
LORAIN CO.
MAP DEPT.
DATE 2-18-93
PAGE 6-27
CAROLYN
BY FRANCIS
VOID # 20260
AETER

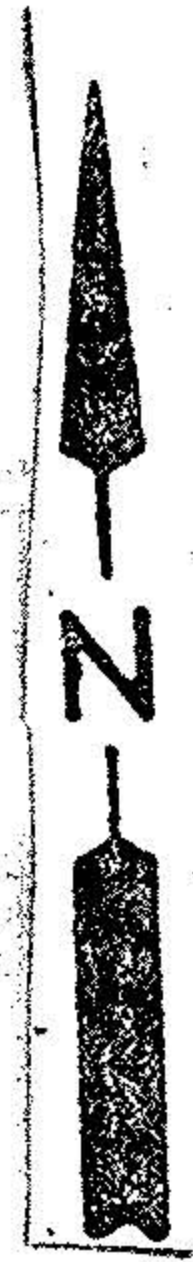

Survey of a parcel split
Original Lot 13
Brace Tract
Elyria Township
Lorain County Ohio
Scale 1"=100' Jan 20, 93

0.413
0.415

145.78'
S 89° 46' W

- x PK nail
- o iron pipes fd
- o iron pipes set
- Ⓢ subplot numbers

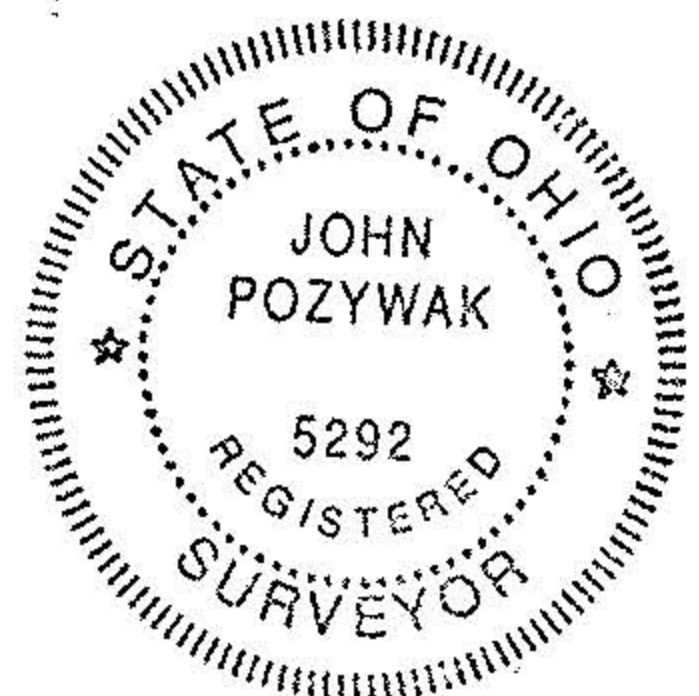

John Pozywak
Reg Surveyor
5292