

FOREST STREET 50'

Donald E. & Eleanor M. Redman  
8/2/84 D.V. 1345, P.752

Dean T. & Loretta P. Williams  
1/00/62

Ronald W. & Kim L. Gambish  
8/30/72 D.V.1057, P.781

PARCEL 1  
0.1073 AC.

PARCEL 2  
0.1073 AC.

Julianna Robles

Chiseled Cross Found & Used  
At Northwest Corner Park  
Avenue & Spring Street

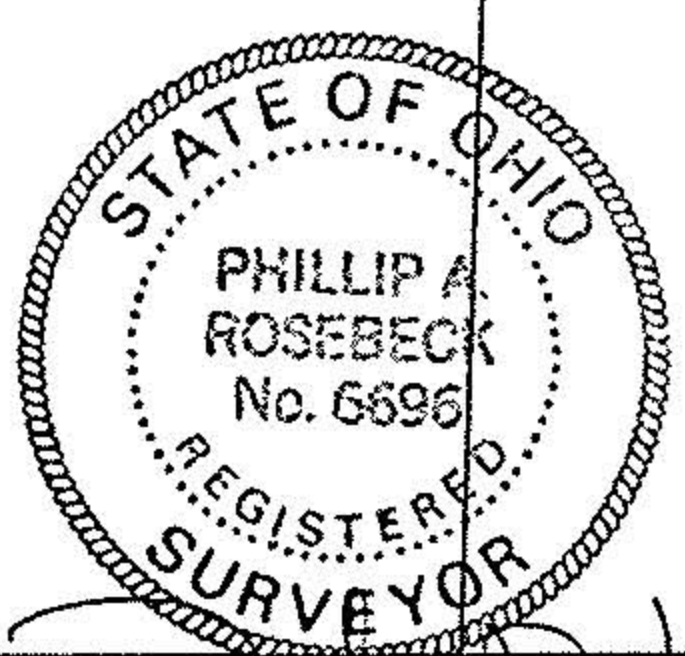

Genevieve A. Kohart

Virginia S. Kasper  
4/13/86 D.V.1419, P.67

PARK AVENUE

LEGEND

- DENOTES IRON PIPE FOUND
- DENOTES IRON PIN SET

PROPOSED LOT SPLIT  
**RICHARD & NANETTE PETERS**  
PART OF SUBLOT 92 ONSTINE'S ADDITION  
PLAT VOLUME 1, PAGE 5

PART OF ORIGINAL AMHERST TOWNSHIP LOTS 23  
CITY OF AMHERST, COUNTY OF LORAIN, STATE OF OHIO  
SCALE: 1"=40' NOV. 2, 2001  
P.A. ROSEBECK & ASSOCIATES - REGISTERED SURVEYOR  
705 WILLOW CREEK DRIVE, AMHERST, OH 44001 (440)988-4657

GRAPHIC SCALE



( IN FEET )  
1 inch = 40 ft.

No 00 52

APPROVED	
LORAIN CO.	
MAP DEPT	
DATE	12-27-01
PAGE	5-00-023-B
BY	JHAT FIELD
01-00	952

