

1" = 20'

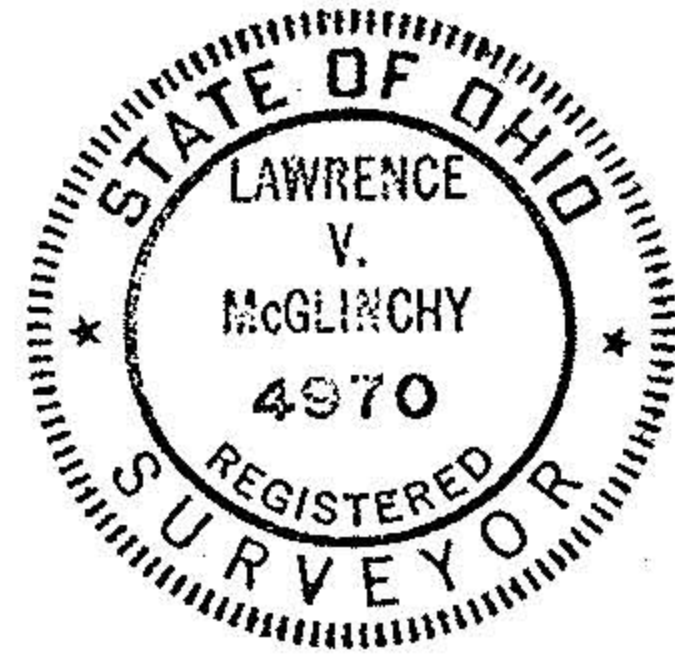

MAP of SURVEY of PROPOSED
PARCEL SPLIT FOR
DR. ROBERT L. EVANS

PART of P.P. # 05-00-024-107-005, -006 & -007

VOL 1190 P 708 ✓

PART of S.L. # 154 & 155 in HARRIS HEIRS ADDITION
PLAT VOL 2 PG 3
PART of ORIGINAL AMHERST TWP. LOT 24
NOW IN CITY of AMHERST, OHIO

TM 05-00-024 B

#16332

APPROVED
LORAIN CO.
MAP DEPT.

DATE 8-22-85

PAGE 5-00-024-B

BY T. McMain

VOID
IF
RETF

McGLINCHY & ASSOCIATES, INC.
REGISTERED SURVEYORS
JUNE 1985 #858757