

SCALE: 1"=60'

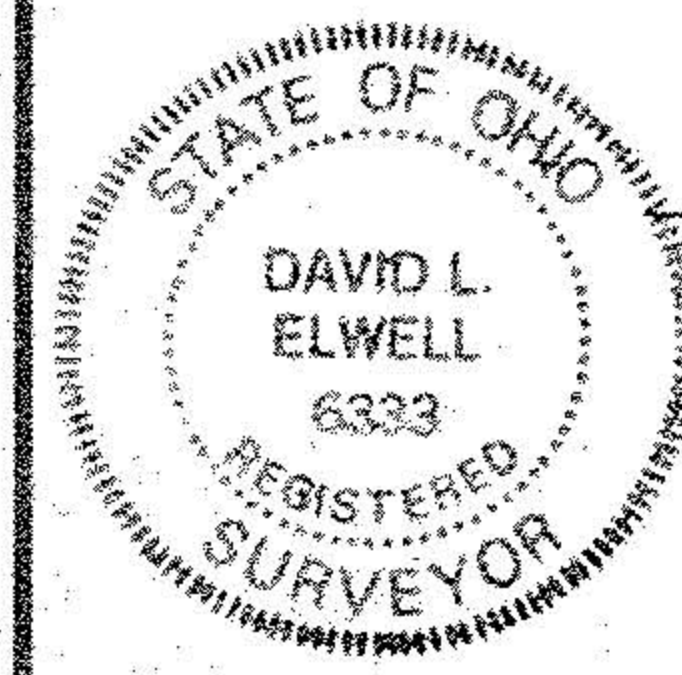

21275 A
APPROVED
LORAIN CO.
MAP DEPT
DATE 4-6-95
PAGE 5-00-003-A
5-00-098-A
BY CAROLYN
FRANCIS
21275 A



SURVEY MAP
PART OF AMHERST TOWNSHIP ORIG. LOT NOS. 3 & 98
CITY OF AMHERST
COUNTY OF LORAIN STATE OF OHIO
FEBRUARY 27, 1995

David L. Elwell
REG. SURV. NO. 6333

05-00-003-A

PRINTED
MAR 08 1995
KS ASSOCIATES, INC.

PREPARED BY:
KS ASSOCIATES, INC.
ENGINEERS SURVEYORS