

A SURVEY PLAT

ASCERTAINING THE REMAINING ACREAGE
OF PROPERTY BELONGING TO ROGER W. & DIANA E.
VALENTINE SITUATED IN THE WEST-MID PART OF
LOT 39, TRACT 5 IN HUNTINGTON TOWNSHIP,
LORAIN COUNTY, OHIO.

Frederick W. Boreman

FREDERICK W. BOREMAN, P.S.
REGISTERED SURVEYOR No. 6855
DECEMBER 1, 1988

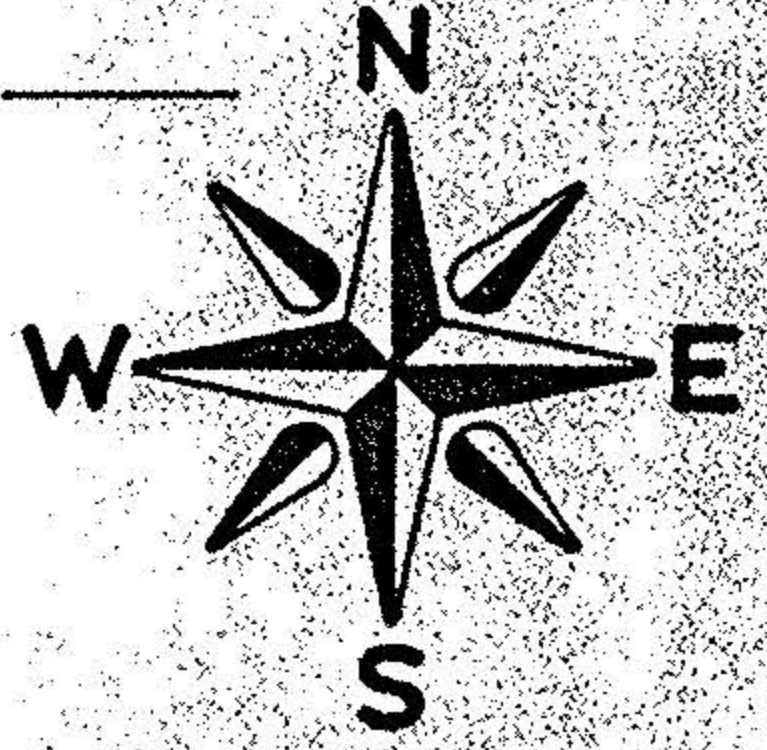

SCALE: 1"=100'

60' R/W

C-30

QUARRY ROAD

N-1°15'00"-E
1726.02' REC. & OBS.

ROCHESTER TWR
HUNTINGTON TWR

N. LINE LOT 39

S-87°45'48"-E
587.13' REC.

VALENTINE

6.0000 ACRES

-015

S-87°45'48"-E
586.94'

ROGER W. & DIANA E.
VALENTINE (11.2003 AC) (TOTAL)
10.6255 AC. OUTSIDE
0.5748 AC. INSIDE RD. R/W
(DEED VOL. 1180 p. 77)

-014

TRACT 5

#20419A.

LOT 39

#18825A

APPROVED
LORAIN CO
MAP DEPT.

DATE 2-8-90

PAGE 21-A

BY CAROL
FRANCIS

VOID
AFTER # 18825A

DALE R.
ZIEGLER - REC. 60.67 ACRES
(DEED VOL. 1178 p. 816)

APPROVED
LORAIN CO.
MAP DEPT.

Ac. CORR.

STATE 7-12586.52 REC.

PAGE 21-A

NAIL BOX
BY *Walter M. B*

VOID
AFTER 2049A

WALTER M. B

ANNA L. THOMAS

REC. 5.0028 ACRES

(VOL. 1206 p. 243)

- X R.R. SPIKE FD.
- O 5/8" DIA. REBAR SET
WITH CAP STAMPED,
"BOREMAN-6855"
- X R.R. SPIKE SET
- 1" DIA. PIPE FD.

C-43

GRIGGS

ROAD

N-88°23'43"-W
586.33' REC.

LOT 39
LOT 38

IRON PIN FD. & USED
INSIDE MONUMENT BOX

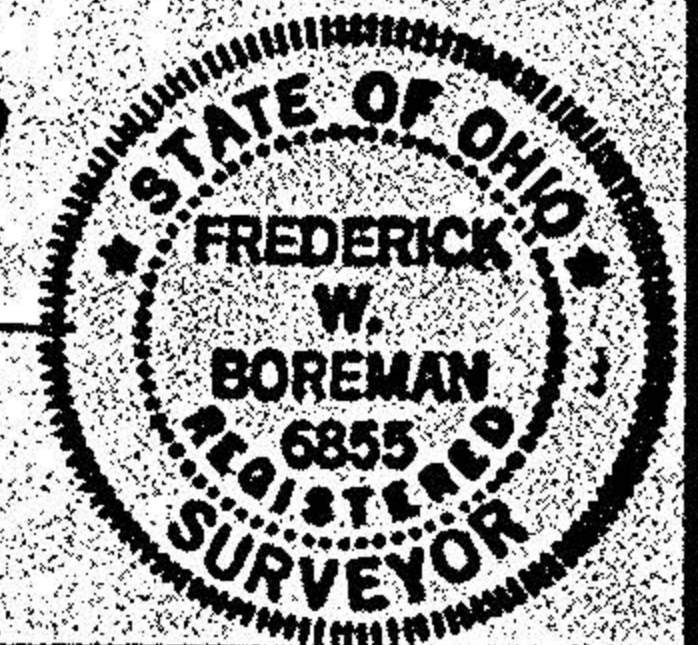

FREDERICK W. BOREMAN, P.S.

P.O. BOX 34, SPENCER, OHIO, 44275

AREA CODE (216) 648-2530

PROJECT No. 88-27a