

JOHN W. WARDEN
CIVIL ENGINEER AND SURVEYOR
1000 ...
COLUMBUS, OHIO

8660

4-00-006

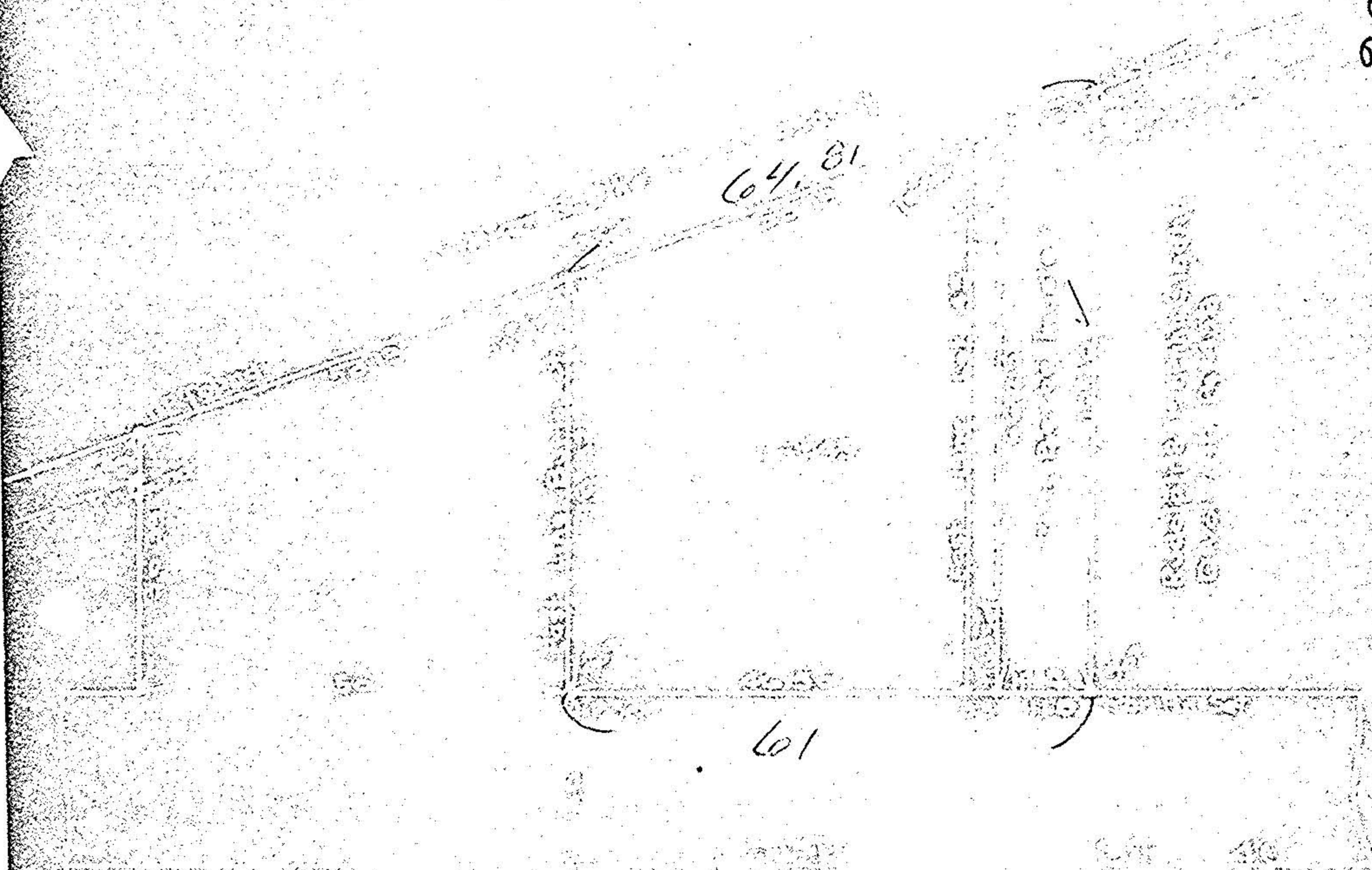

lot

APR 2 1975

06.6

Survey for
GEORGE W. C. LETHBRIDGE SCHNEIDER
Sub Lot 45 - Beach Park Allotment 40/100
Map No. 6 - P.O.C. 50
Part of Original Section 6
Township 10 N. Range 10 E. Co. 6

JOHN W. WARDEN
CIVIL ENGINEER AND SURVEYOR
1000 ...
COLUMBUS, OHIO

8660

4-00-006-D

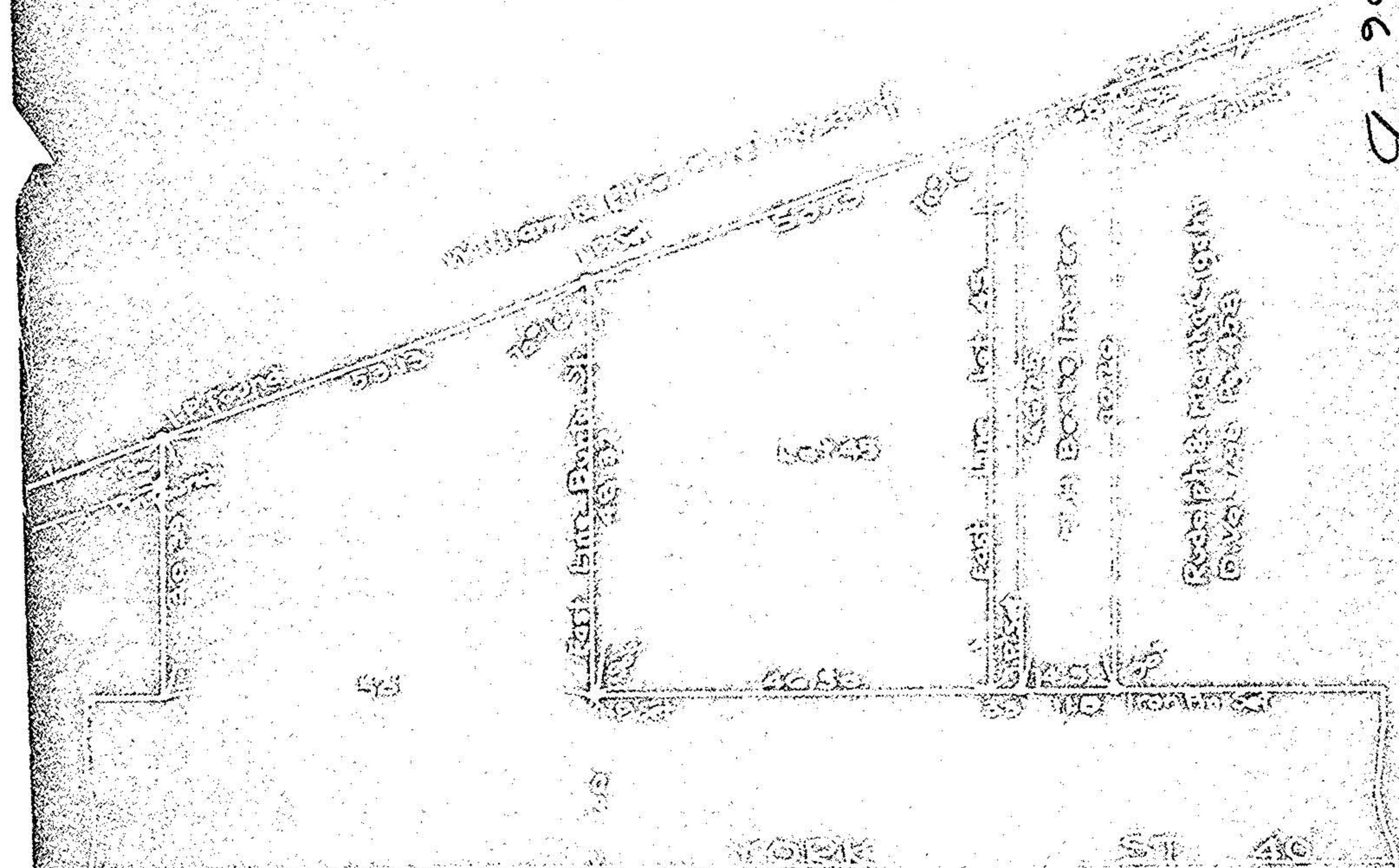

lot 45

Survey for
GEORGE W. C. LETHBRIDGE SCHNEIDER
Sub Lot 45 - Beach Park Allotment 40/100
Map No. 6 - P.O.C. 50
Part of Original Section 6
Township 10 N. Range 10 E. Co. 6

06.6