

#22157

SURVEY MAP

APPROVED	
LORAIN CO. MAP DEPT.	
DATE	4-25-97
PAGE	3-00-005A
BY	R. BELL
VOID AFTER #	22157

PART OF ORIGINAL SHEFFIELD TOWNSHIP LOT NO. 5
VILLAGE OF SHEFFIELD, COUNTY OF LORAIN, STATE OF OHIO

03-00-005-000-050
METOKOTE CORP. O.R.V. 166, P. 273
33.77 AC REM.

1" Iron Pin
Fd. & Used

S 87°45'31"E

ABBE ROAD 60'

1836.84' OBS.

5/8" IRON PIN
W/CAP #7065
FD. & USED

03-00-005-000-049
ROBERTSON HEATING SUPPLY CO.
O.R. V. 1387, P. 528

5/8" IRON PIN
W/CAP #7065
FD. & USED

249.00' CALC.

5/8" IRON PIN
W/CAP MARKED
T.J. NEFF-7065
SET

1.2936 AC

2.0007 AC

N 02°14'29"E 350.00' CALC.

S 02°14'29"W 350.00' CALC.

S 02°14'29"W 350.00' CALC.

249.00' CALC.

161.00' CALC.

P.K. NAIL SET
IN HEADWALL
0.50'S

530.00' CALC.

249.00' CALC.

S 87°45'31"E 1367.92' REC. & USED

Drillhole
Fd. & Used

EVERGREEN PARKWAY 65'

R.R. Spike Fd.
0.08'E
Used
for line

N 02°14'29"E

915.33' CALC. 915.30' REC.

0 50' 100'

SCALE IN FEET

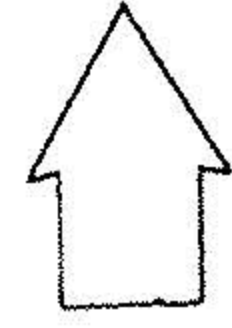

NORTH

Distances shown hereon are given in feet and decimal parts thereof. Bearings shown hereon are to an assumed meridian and are used to denote angles only.

I hereby state to the best of my professional knowledge, information and belief, all to be correct.

R.R. Spike Fd. & Used

SHEFFIELD-FRENCH CREEK RD.

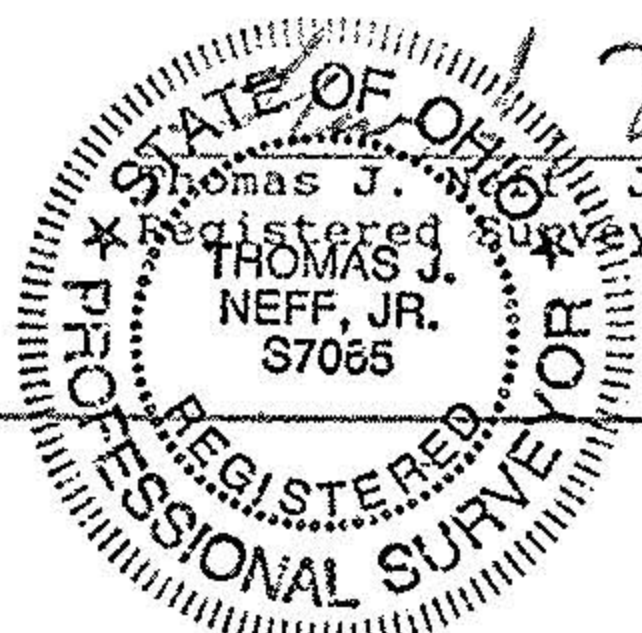

Thomas J. Neff, Jr.

THOMAS J. NEFF, JR.
S7065
Registered Surveyor No. 7065-Ohio



NEFF & ASSOCIATES

PLANNERS • ENGINEERS • SURVEYORS

6415 Stumph Road Parma Heights, Ohio 44130

SCALE	1" = 100'
DATE	MARCH 7, 1997
JOB NO.	11126
DRAWN BY	G.M.B.