

SURVEY MAP  
FOR  
INES LUSTRI

SITUATED IN THE VILLAGE OF SHEFFIELD, COUNTY OF LORAIN  
AND STATE OF OHIO, AND KNOWN AS BEING PART OF ORIGINAL  
LOT NO.6 OF SHEFFIELD.

DATE: 11-8-95 BY: BRUNSWICK SURVEYING  
SCALE: 1" = 100' PH. 225-3000

FORMERLEY THOMAS RAKOVAN VOL. 515 PG. 417  
APPLE CREEK SUBDIVISION

VILLAGE OF SHEFFIELD

CLEVELAND  
ELECTRIC  
ILLUMINATING CO.  
VOL. 959 PG. 609

256.63 OBS.

CITY OF AVON

R.R. SPIKE FND.  
& USED

1789.05 REC.  
1788.15 OBS.

1.57 W

1.57

S 88° 05' 19" E

1.47 W

2451.70 REC. 2451.72 OBS. TO €

INES LUSTRI  
13.424 ACRES TO €  
13.256 ACRES TO R/W

LEGEND

- ▲ = RAILROAD SPIKE FOUND
- ✕ = P.K. NAIL SET
- ⊙ = 1/2" IRON PIN SET CAPPED
- = 1 1/4" IRON PIN FOUND & USED
- = 7/8" I.D. PIPE FOUND

ABBE ROAD 60' S.R. 301

N 02° 14' 29" E

244.27 OBS.

244.12

EXIST.  
GAS LINE

2449.69 OBS. TO €

S 88° 21' 12" E

CONSOLIDATED RAIL CORPORATION VOL. 93 PG. 533

S 88° 21' 12" E

1621.58 REC. TO €  
1621.95 OBS.

HARRY & CHRISTA GERENT  
VOL. 1231 PG. 239

DISTANCES ARE EXPRESSED IN FEET AND DECIMAL.  
PARTS THEREOF. IRON PINS WERE FOUND OR SET  
AS INDICATED, BEARING ARE TO AN ASSUMED  
MERIDIAN AND ARE USED TO INDICATE ANGLES  
ONLY. ALL OF WHICH I CERTIFY TO BE CORRECT.

REC. Δ = 33° 01' 00"  
OBS. Δ = 32° 59' 25"  
REC. CH. = 512.62  
OBS. CH. = 512.74

*Daniel M Powers*

DANIEL M POWERS REG. NO. 7541

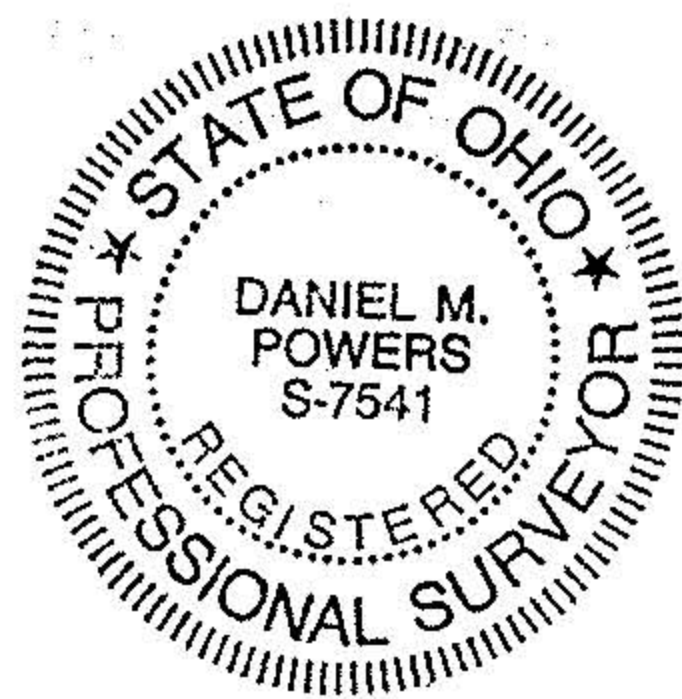

R.R. SPIKE  
FND. & USED.

FRENCH CREEK

232.97 OBS.

577.50 REC.

S 02° 45' 55" W

5.5'

#22682-A

APPROVED	
LORAIN CO.	
MAP DEPT.	
DATE 10-20-98	
PAGE 3-00-006-A	
BY TJS	
VOID AFTER	22682