

3-60-020-A #18246 03-00-020-000
4-050-00-015
O.L. 20
03-00-020-000

JOHN DECHANT

D.V. 1227 P. 927

N-89°53'10"-W 325.40' 171.20' S-89°53'10"-E
I.P. Fd. 16.63' ESMT. 15' I.P. Set
164.12'

601.82'

VERONIKA BARTON

HILDA BERENSCI

4.654 AC.

D.V. 1296 P. 198

#18246

APPROVED
LORAIN CO.
MAP DEPT.

DATE 12-6-88

PAGE 3-00-020-A

BY T. McMain

VOID AFTER 18246

due SOUTH

I.P. Fd.

610.52 R.

P.K. Set

N-89°40'30"-E

300.00'

P.K. Set

N-89°40'30"-E

197.37'

ESMT.

15'

198.25

200.00'

I.P. Set

P.K. Set

OSTER

ROAD

N-6°52'40"E 90.28'
EXISTING DITCH
N-40°29'30"E 76.21'
N-14°16'W 52.21'
N-4°24'30"W 50.34'
N-23°14'-E 53.48'
N-101°10'W 115.38'
N-25°30'W 16.63'

- 015
2.2086 AC.

598.00'

N-0°19'30"-W

D.V. 798

P. 697

PCL. I

FREDERICK F. MITTENDORF

ABBE ROAD

NORTH

David L. Elwell

REG. SURV. No. 6333

Nov. 5, 1988

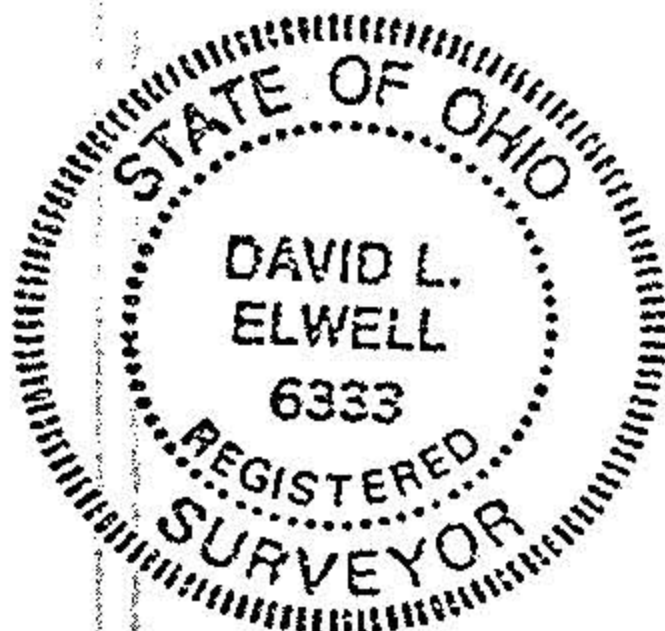

BOUNDARY SURVEY

PART OF
SHEFFIELD TWP. O. LOT. 20
VILLAGE OF SHEFFIELD
COUNTY OF LORAIN
STATE OF OHIO

PREPARED BY
KS ASSOC. INC.
ENGINEERS SURVEYORS

SCALE: 1" = 100'