

NORTH

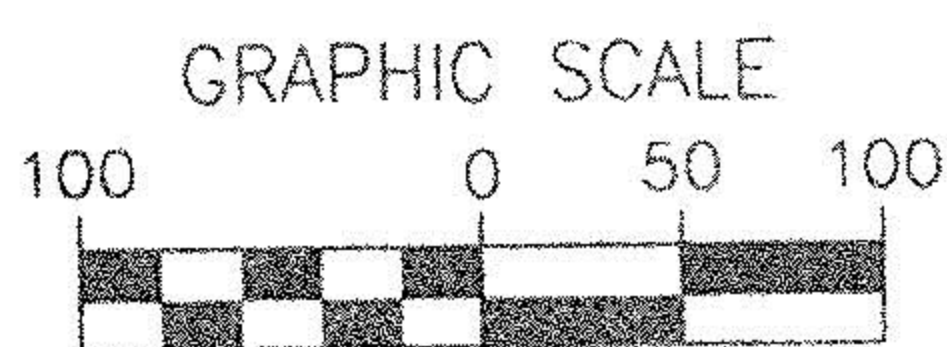

1 INCH = 100 FT.

Date: November, 1997
File No. 11349

S 88°28'24" E
30.00' r.&u.

03-00-006-000-007
Harry R. and Christa E. Gerent
Vol. 1231 Pg. 239 L.C.D.R.

S 88°28'24" E
910.07' calc.

2114.46' calc. 2114.49' rec.

1" iron pin
fd. & used

5/8" iron pin
(#7065) set

5/8" iron pin
(#7065) set

7/8" iron pipe
fd. & used

997.43' rec. & used

976.66' calc.

Area in O.L. 6
337,873 sq.ft.
7.7565 acres

Total Area
621,440 sq.ft.
14.2663 acres

03-00-005-000-050
MetoKote Corporation
O.R. Vol. 166 Pg. 273 L.C.D.R.

O.L. 16

O.L. 6

O.L. 15

O.L. 5

Area in O.L. 5
283,567 sq.ft.
6.5098 acres

N 02°14'29" E
615.30' calc.

5/8" iron pin
(#7065)
fd. & used

5/8" iron pin
(#7065)
fd. & used

PLAT of SURVEY

Situated in the Village of Sheffield, County of Lorain,
State of Ohio and known as being part of Original
Sheffield Township, Lot Nos. 5 and 6.

ABBE ROAD 60'

N 02°14'29" E
921.51' obs.

N 87°45'31" W
749.00' calc.

500.00' d.&obs.

249.00' d.&obs.

5/8" iron pin
(#7065)
fd. & used

03-00-005-000-049
Belden Village Lighting Center, Inc.
O.R. Vol. 1453 Pg. 456 L.C.D.R.

03-00-005-000-051
Kevin B. and Eleanor R. McLaughlin
O.R. Vol. 1480 Pg. 955 L.C.D.R.

5/8" iron pin
(#7065)
fd. & used

P.K. nail set
in headwall
0.50' S.

N 42°45'31" W
48.08' d.&u.

N 87°45'31" W
146.00' d.&u.

N 81°28'53" W
100.60' d.&u.

220.00' d.&u.

779.00' calc.

S 87°45'31" E rec. & used

249.00' d.&u.

N 02°14'29" E
350.00' d.&u.

S 02°14'29" W

Railroad spike fd.
0.08' E.
used for line

N 02°14'29" E
915.30' calc. & rec.

EVERGREEN PARKWAY 65'
(Dedicated Vol. 45 Pg. 12 L.C.M.R.)

1367.92' calc. & rec.

N 02°14'29" E
32.50' r.&u.

N 87°45'31" W
161.00' calc.

Drill hole
fd. & used

SHEFFIELD-FRENCH CREEK ROAD

Railroad spike
fd. & used

Distances shown hereon are given in feet and decimal parts
thereof. Bearings shown hereon are to a record meridian and
are used to denote angles only

I hereby state to the best of my professional knowledge,
information and belief, all to be correct.



NEFF & ASSOCIATES
A PROFESSIONAL CORPORATION
ENGINEERS • PLANNERS
LANDSCAPE ARCHITECTS
SURVEYORS
6405 York Road Parma Heights, Ohio 44130
(440) 884-3100 FAX (440) 854-6447

Thomas J. Neff, Jr.
Thomas J. Neff, Jr.
Registered Surveyor No. 7065-Ohio

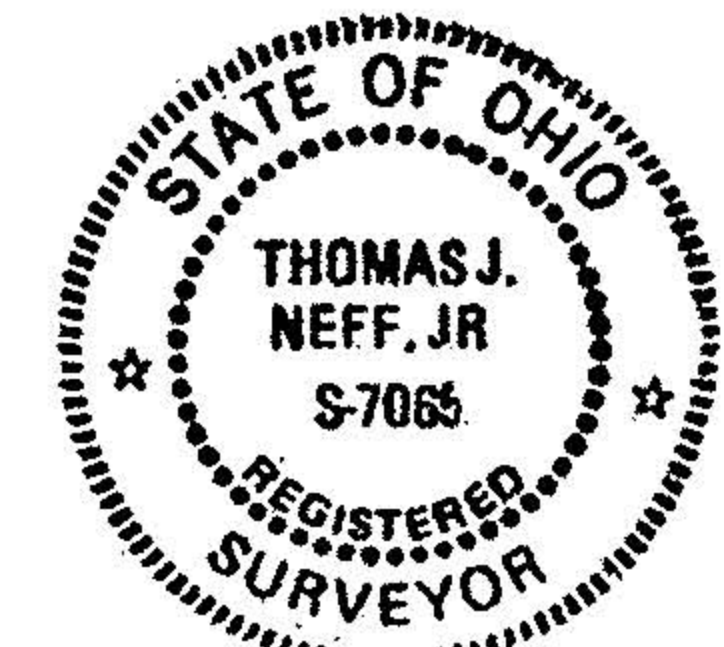

FILED 11/19/97
#22389
12/18/97
3-00-005-A
3-00-006-A
KAC

03-00-005-000-052
into - 053 of
005-212