

R.R. SPIKE USED
N. LINE O. L. 3

HAROLD H. DeCHANT
VOL. 572 PG. 849
PERM. PCL. 3-00-003-000-032
(REMAINDER)

1058.00' DEED & MSD.
N89°39'00"E
N89°37'23"E 1012.12

N89°37'23"E 286.73
SEWER EASEMENT
140

ABBE ROAD
DUE NORTH

360.00 MSD.
353.00 DEED & MSD.
N01°53'40"E 177.88 D. & M.
182.88
40.00
N05°42'40"E 100.50
N - S
77.32

AREA
8.6283 ACRES IN PARCEL 018
0.1101 ACRES IN PARCEL 032
8.7384 ACRES TOTAL

STANLEY J. JR. & PRISCILLA ROGALLA
VOL. 1077 PG. 248
PERM. PCL. 3-00-003-000-006

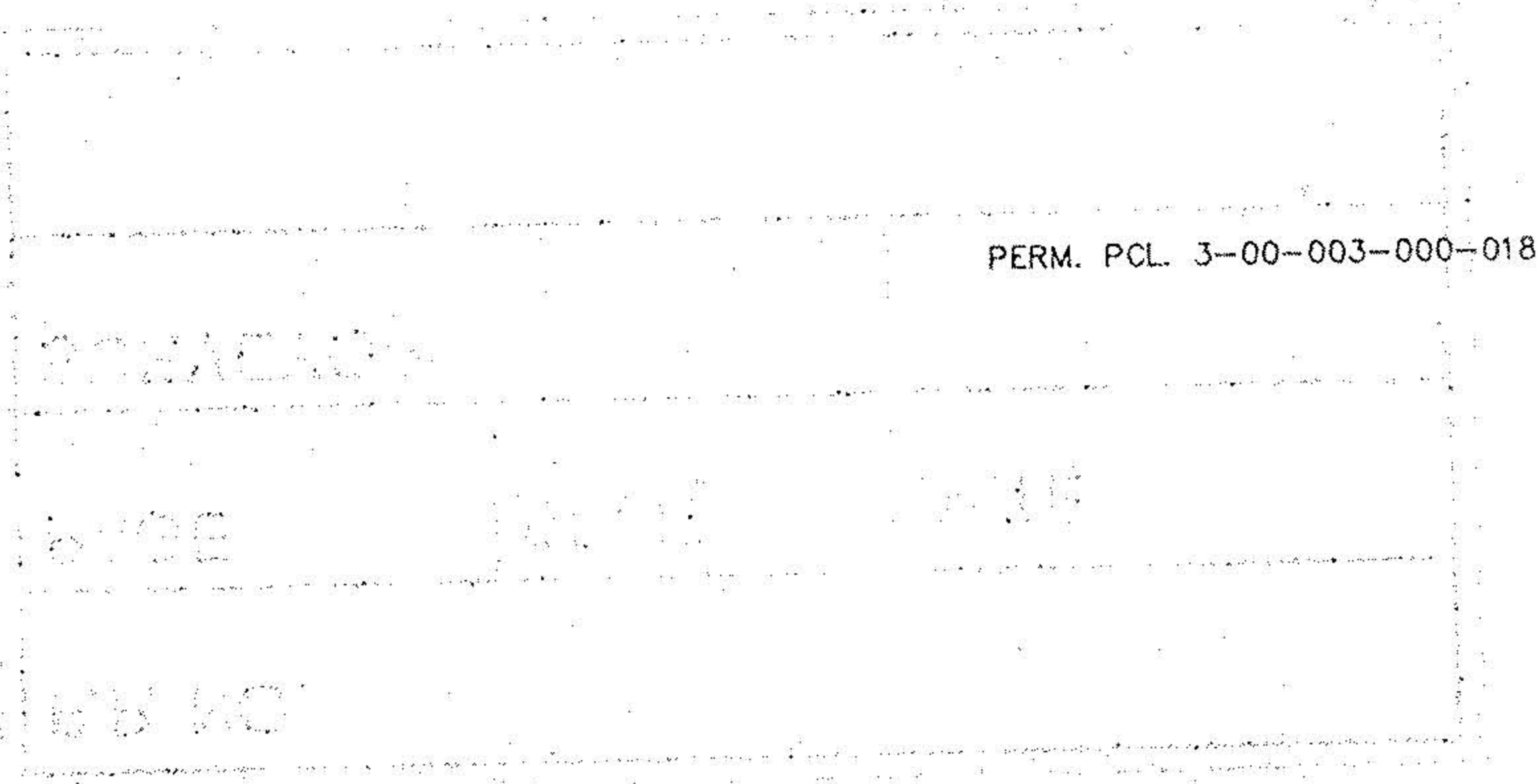

N89°39'00"E
1058.00 DEED & MSD.

N89°52'00"E REC. & USED
140.54'

1. PIPE USED
2.50 W. OBS.
PERM. PCL. 3-00-003-000-027

ALVA AND WANDA SUE DOTSON
VOL. 1214 PG. 187

PERM. PCL. 3-00-003-000-039

SURVEY
OF
8.7436 ACRES on ABBE ROAD
IN ORIG. SHEFFIELD TWP. LOT. NO. 3
FOR
HAROLD H. DeCHANT

BY THE HENRY G. REITZ ENG. CO.
4214 ROCKY RIVER DR.
CLEVELAND, OHIO 44135

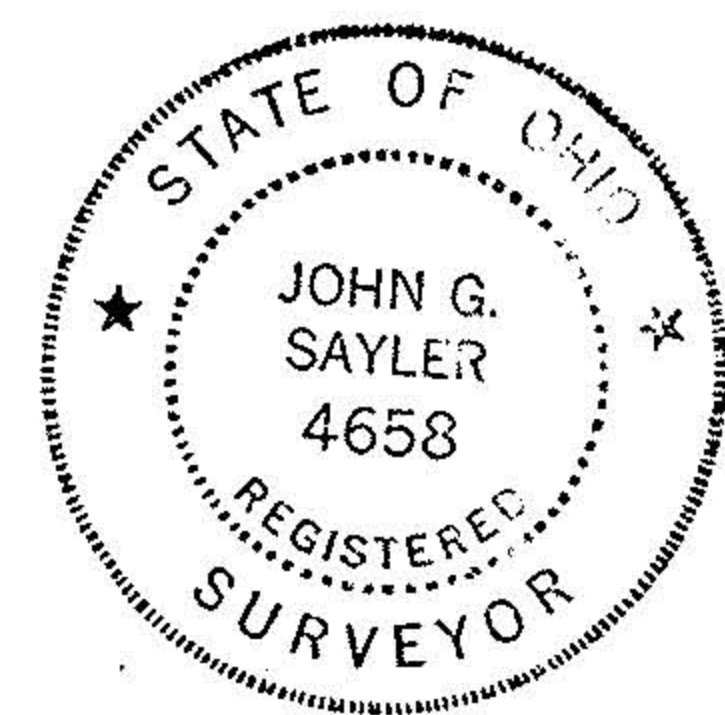

BY *[Signature]* PRES.
REG. SURVEYOR NO. 4658

SCALE 1" = 60'
APR., 1994
REV. 7-27-94

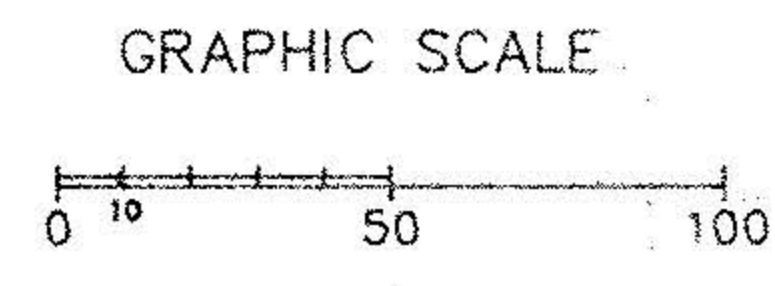

VILLAGE RESERVE SUBD. NO. 1
VOL. 47 PAGE 57

$\Delta = 40'35'27''$
R = 405.60'
T = 150.00'
L = 287.34'

N70°08'23"W
98.09'

$\Delta = 37'45'30''$ T = 195.95'
R = 573.00' L = 377.61'

$\Delta = 00'59'26''$
R = 573.00'
T = 4.95'
L = 9.91'

$\Delta = 20'34'23''$
R = 700.00'
T = 127.04'
L = 251.35'

40.00 I. MON USED
N89°50'33"E 120.00' I. MON USED

392.00
O.L. 3
O.L. 2

#20980
APPROVED
LORAIN CO.
MAP DEPT.
DATE 4-17-94
PAGE 3-00-003-A
BY T. Merkin
12