

3056
3056



P.P. # 03-00-056-114-004
BLOCK 'C' OF C.J. CREHORE
THIRD ALLOT. PLAT VOL. 9,
PART OF ORIG SHEFFIELD
LOT 56 - NOW IN CITY OF
LORAIN, OHIO

3-00-056-A
#10188

McELINCHY & ASSOCIATES
AUG. 11, 1976 #761162

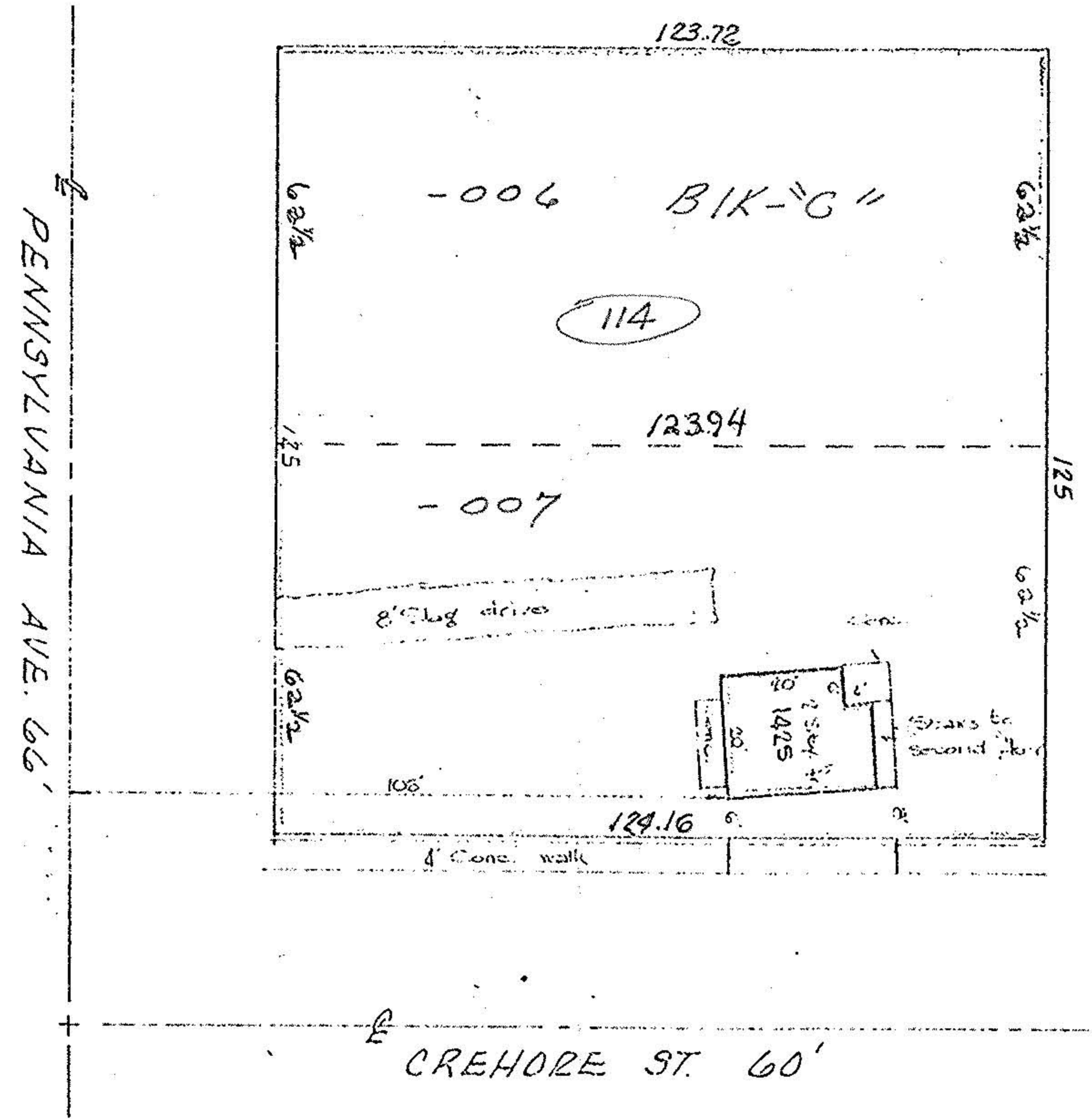

Patricia M. Shannon
APPROVED

APPROVED BY THE LORAIN CITY PLANNING
COMMISSION... NO PLAT REQUIRED
Tommy Rodgers
SECRETARY LORAIN CITY PLANNING COMMISSION

60
50
40