

#22413-A
 APPROVED
 LORAIN CO.
 MAP DEPT
 DATE 1/23/98
 PAGE 3-A
 BY K. Colbert

PLAT OF SURVEY & LOT SPLIT
 FOR
MICHAEL NAPOLI
 TO ACCOMPANY LEGAL DESCRIPTIONS
 BEING A LOT SPLIT OF MICHAEL J. NAPOLI, VOL. 446 - PG. 460
 KNOWN AS BEING PART OF ORIGINAL SHEFFIELD TOWNSHIP LOTS 53 & 54
 SITUATED IN THE CITY OF LORAIN, COUNTY OF LORAIN, OHIO
 SCALE 1"=100'
 JULY 1992

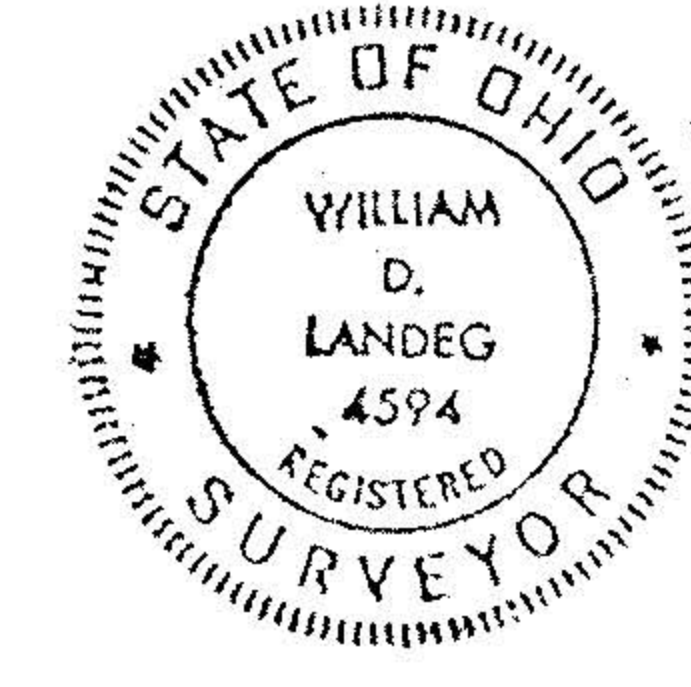

CERTIFICATION
 THIS IS TO CERTIFY THAT AT THE REQUEST OF THE OWNER I HAVE SURVEYED AND PLATTED THE PARCEL AS SHOWN HEREON AND CONTAINING 6.5616 ACRES OF LAND. AT ALL POINTS SO INDICATED, IRON PIN MONUMENTS WERE EITHER FOUND OR SET. DISTANCES ARE SHOWN IN FEET AND DECIMALS THEREOF. BEARINGS SHOWN ARE BASED UPON AN ASSUMED MERIDIAN AND ARE FOR THE SOLE PURPOSE OF DESCRIBING THE RELATIVE ANGULAR VALUE BETWEEN LINES, ALL OF WHICH I CERTIFY TO BE CORRECT TO THE BEST OF MY KNOWLEDGE & BELIEF.
 WILLIAM D. LANDEG PS. #4594

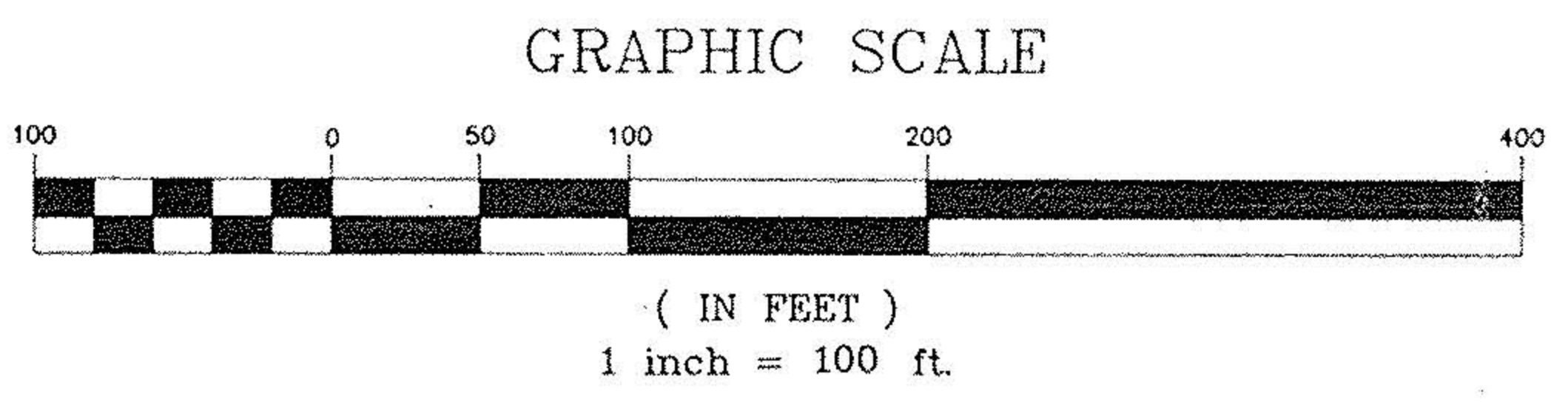

PRINTED
 APR 22 1993
 LAKE INC.

Lake Inc.
 Engineers & Surveyors
 30601 EUCLID AVE. WICKLIFFE, OHIO