



LAUNDON . SIMON . CAHL & ASSOC. INC.
CONSULTING ENGINEERS & SURVEYORS
219 COURT ST. ELYRIA, OHIO 44035

SURVEY FROM

JEFFERSON TRUCKING CO.

Orig. Lot 53	City of LORAIN	Date 5-15-89 Scale 1"=100
Orig. Sec	Village of	Dwn. by R.G.S. Chkd. by
Tract	County of LORAIN	Job No. 89-1817 F.B.
Township of SHEFFIELD	State of OHIO	Printed MAY 19

THIS IS TO CERTIFY THAT NO BILLBOARDS
EXIST ON THE PROPERTY AS SHOWN HEREON

COLORADO AVE.

RODGER G. SIMON
REG. SURVEYOR NO 5101

#18465

APPROVED
LORAIN CO.
MAP DEPT
DATE 6-1-89
PAGE 3-00-053 A
BY CAROL T
#18465

JEFFERSON TRUCKING CO.
V.1383 P.544

N. 87° 54' 06" W. 650.00

APPROVED BY THE LORAIN CITY PLANNING
COMMISSION NO PLAT REQUIRED

Patrick A. McE...
SECRETARY LORAIN CITY PLANNING COMMISSION

5.2227 Ac.

APPROVED

AS TO DESCRIPTION ONLY

Date 26-May-1989

Per Patrick A. McE...
City of Lorain
Engineering Dept.

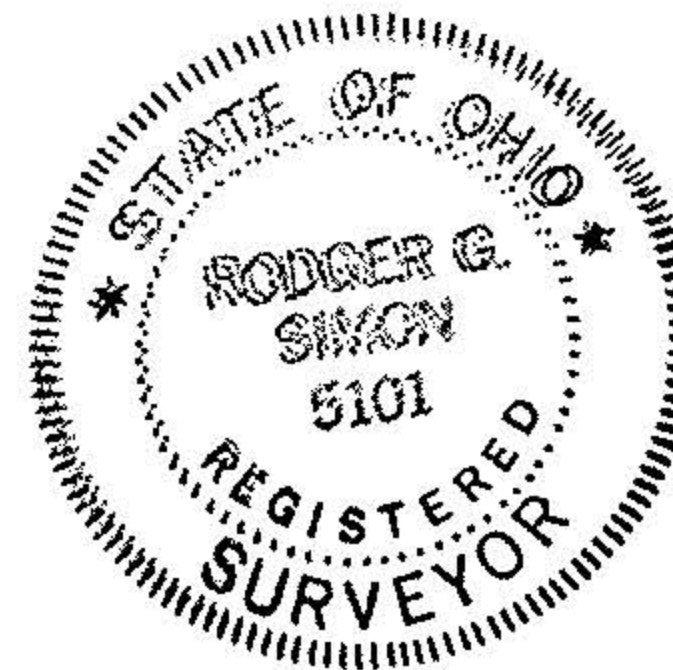

S. 87° 54' 06" E. 650.00

N.Y.C. R.R. & N.Y. CHICAGO AND ST. LOUIS R.R.
1762 P.122

3-00-053-A #18465 03-00-053-108

U.S. STEEL CORP.
V.937 P.897

S. 2° 07' 35" W. 350.00

94.56
60
214.71

614.56
400.0

KAM PARTNERSHIP
V.1327 P.408

MICHAEL NAPOU ET AL

350.00
S. 2° 07' 35" W.

SET
I.P.

I.P. SET