

Scale 1" = 100'

April 29, 1995

LINE	BEARING	DISTANCE
L 2	N 89° 11' 20" W	30.52'
L 3	N 88° 56' 00" W	28.70'
L 4	S 88° 13' 00" W	30.29'
L 5	S 87° 52' 15" W	30.27'

Note: Bearings shown are to an assumed meridian and are used to describe angles only.

Note: Only copies signed with Red Ink shall be considered Valid.

*Patrick A. McGannon*  
Patrick A. McGannon P.S. 7154

Prepared for Iren Kun  
of 5000 Elyria Avenue  
Sheffield Township.

Being known as Part of Original Lot 112

In the State of Ohio.

**21491**

APPROVED  
LORAIN CO.  
MAP DEPT

DATE 9-14-95

PAGE 3-00-112-B

BY CAROLYN  
FRANCIS

#21491

Hayes P. And Kathy M. Satterfield  
O.R. 309 Page 579

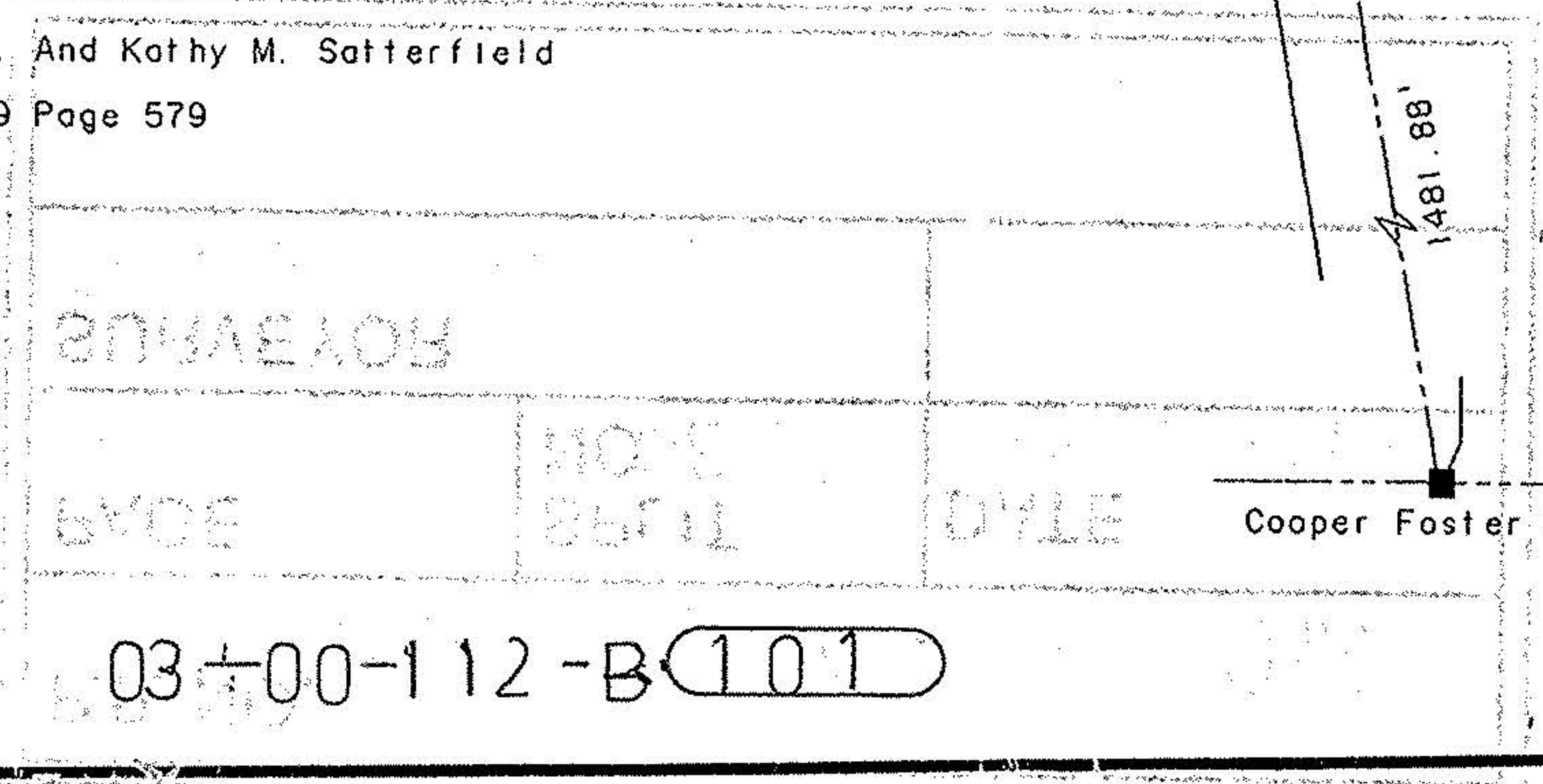

### Boundary Survey

**Patrick A. McGannon, Registered**  
**Professional Surveyor**

1731 Gettysburg Drive, Lorain, Ohio., Ph (216) 282 2712

