

⊙ - N 41° 27' W

Ⓐ 0.244 Acre School St 50'

Emma J & John L Burch : owners
DIV 1207 Pg 334 sublots 104-106, 135-137

○ iron pins fd
● iron pins set

John Pozywak
Registered Surveyor

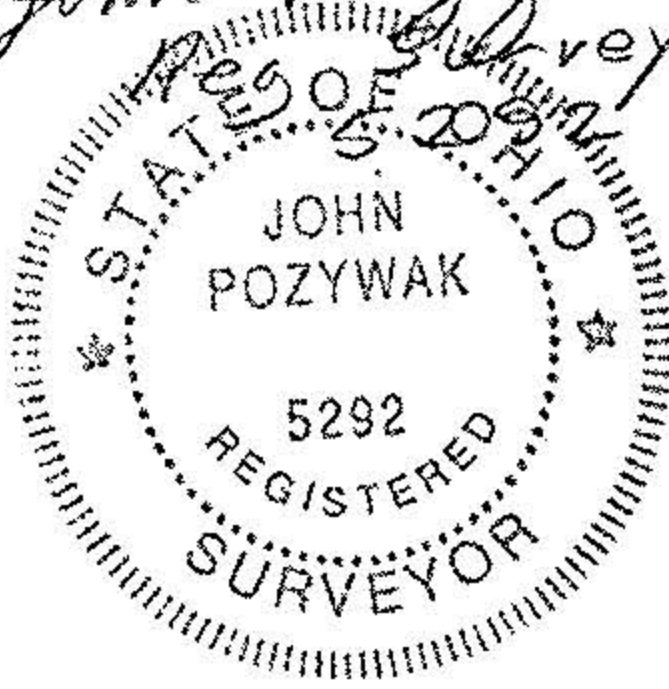

Survey of Parcel Split
of sublot 105 & 136
Rolling Heights Allotment
Plat Vol II Pg 24
Original Lot III
Sheffield Township

Lorain County Ohio
Scale 1"=60' July 1998
Revised Aug 13, 1998
March 1999

Sublot	Sq footage	Take	Rew
104	77		21996
105	1363		17977
106	282		14178
137	423		13277
136	5756		13524
135	4437		10023

99-00084

APPROVED LORAIN CO. MAP DEPT
DATE 4-28-99
PAGE 3-00-III-B
BY <i>J. Follett</i>
99-00084