

- DENOTES L PIN IN MONUMENT BOX USED
- DENOTES 5/8" CAPPED IRON PIN SET

SURVEY MAP
P.P. # 4-00-020-104-506
OF PART OF AVON TWP.
SECTION NO. 20
CITY OF AVON LAKE
COUNTY OF LORAIN
STATE OF OHIO

PREPARED BY
THE HENRY G. REITZ ENG. CO.
4214 ROCKY RIVER DR.
CLEVELAND, OH 44135
(216) 251-3033
MARCH 30, 1993

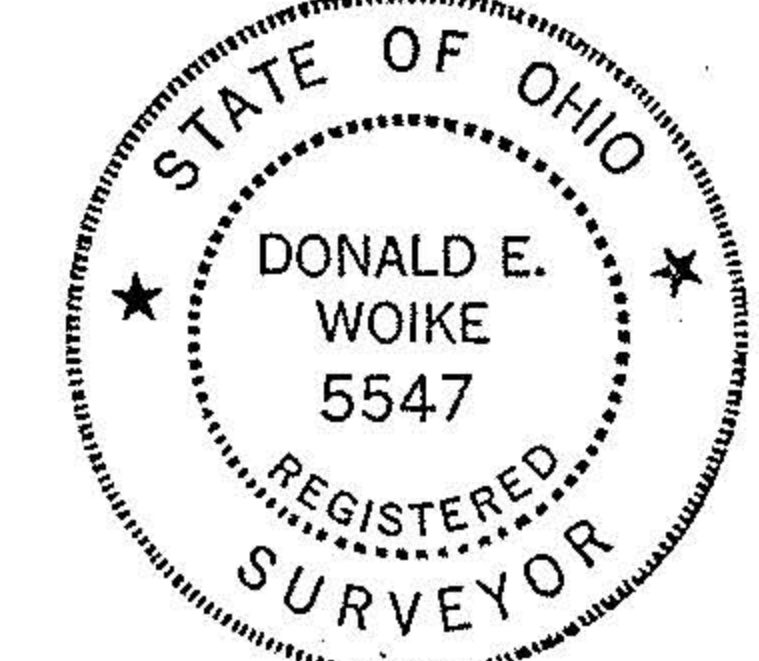

BY *Donald E. Woike*
DONALD E. WOIKE, V.P.
REG. SURVEYOR # 5547

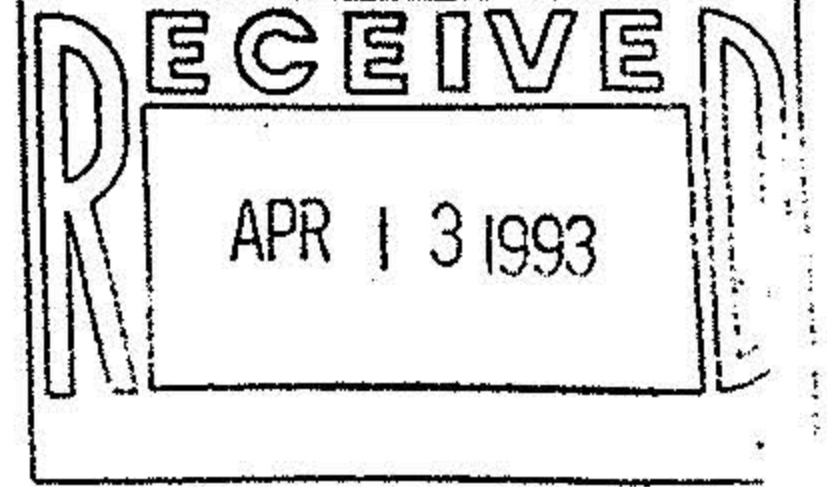

☪ EAST BOUND TRACKS
NORFOLK & WESTERN RAILROAD