

21244

APPROVED
LORAIN CO.
MAP DEPT

DATE 3-1-95

PAGE 4-00-019-F

BY CAROLYN FRANCIS

21244
PRINTED

APR 27 1995
KS ASSOCIATES, INC.

- LEGEND
- IRON PIN FOUND
 - IRON PIN SET
 - ▽ HYDRANT
 - ⊙ MANHOLE
 - ⊥ POLE
 - ◆ MONUMENT BOX F.D.

David L. Elwell
REG. SURV. NO. 6333

PREPARED BY:
KS ASSOCIATES INC.
ENGINEERS SURVEYORS

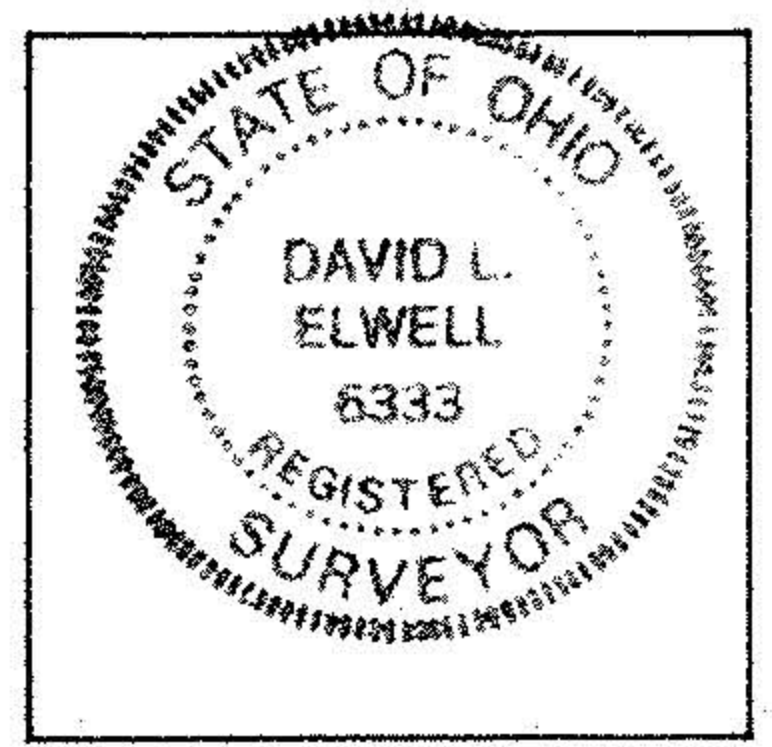

SURVEY MAP
PART OF AVON TOWNSHIP SEC. NO. 19
CITY OF AVON LAKE COUNTY OF LORAIN
STATE OF OHIO

DATE: NOVEMBER 2, 1993 SCALE: 1" = 100'