

SURVEY MAP

SUBLOT NOS. 1 AND 2 IN
 NOTTINGHAM WOODS SUBDIVISION
 P.V. 36 P.6 & 7
 CITY OF LORAIN COUNTY OF LORAIN
 STATE OF OHIO
 JANUARY 27, 1995
 REVISION 01-31-95

PREPARED BY:
KS ASSOCIATES INC.
 ENGINEERS SURVEYORS
 David L. Elwell
 DAVID L. ELWELL
 REG. SURVEYOR, No. 6333

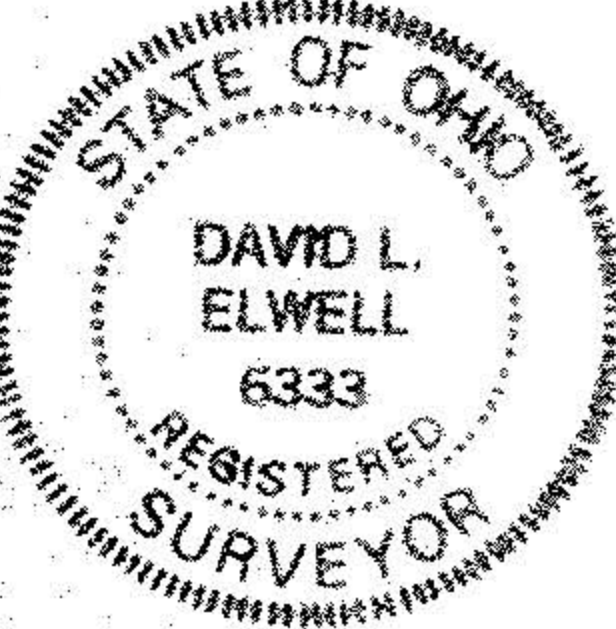

#22099

APPROVED
 LORAIN CO.
 MAP DEPT.
 DATE 3-24-97
 PAGE 2-01-008A
 BY P. BEU
 HOLD AFTER # 22099

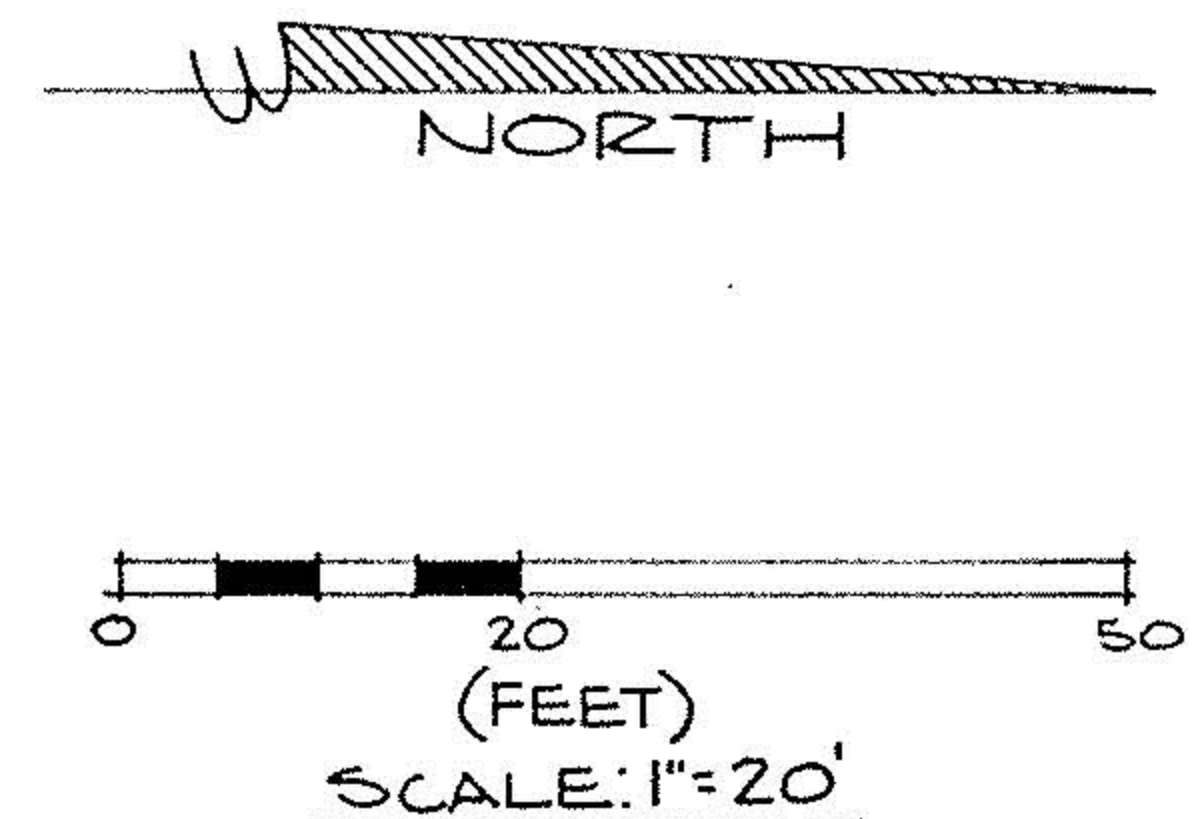

APPROVED BY THE LORAIN CITY PLANNING COMMISSION... NO PLAT REQUIRED
 William E. DeLoe, 33-97
 SECRETARY LORAIN CITY PLANNING COMMISSION

BUILDING ZONE R-1B
 FRONT SETBACK: 40'
 REAR YARD: 35'
 SIDEYARD: 6' & 8' (ATTACHED GARAGE)
 AREA: 9,100 SF
 WIDTH: 70.00'
 DEPTH: 130.00'

APPROVED
 AS TO DESCRIPTION ONLY
 Date 3-March-1997
 Per Patrick D. Mc...
 City of Lorain
 Engineering Dept.

NOTE: THIS SURVEY IS BASED ON RECORD PLAT INFORMATION AND CERTIFICATE OF CORRECTION RECORDED IN O.R.V. 471 P.347

(REF 94-667)
 94-502

02-01-008-101-369

94502