

# 18708 01-00-064-000-046

EDWARD M. & GERALDINE E. NADSDY  
D.V. 897, PG. 458

SCALE: 1"=50'



1.P. 567  
5 00° 09' W 684.97'

- 046  
2.6774 ACRES

S 89° 51' E 185.00'

1.P. 561  
N 00° 09' E 580.00'

GEORGETTE FLEMING  
D.V. 1180, PG. 83

N 76° 47' 30" W  
12.50'

N 59° 15' 50" W 200.75'  
TRINITER ROAD

1.P. 561  
34.85'

1.P. FOUND

**MAP of PROPOSED PARCEL SPLIT**

PREPARED FOR EDWARD NADSDY

PART of ORIGINAL BROWNHELM TWP LOT No. 11-2-89  
TOWNSHIP of BROWNHELM, LORAIN COUNTY, OHIO

# 18708

APPROVED  
LORAIN CO.  
MAP DEPT.

NOV 11-2-89

BY CAROLYN FRANCIS

VOID # 18708

ASTER # 18708

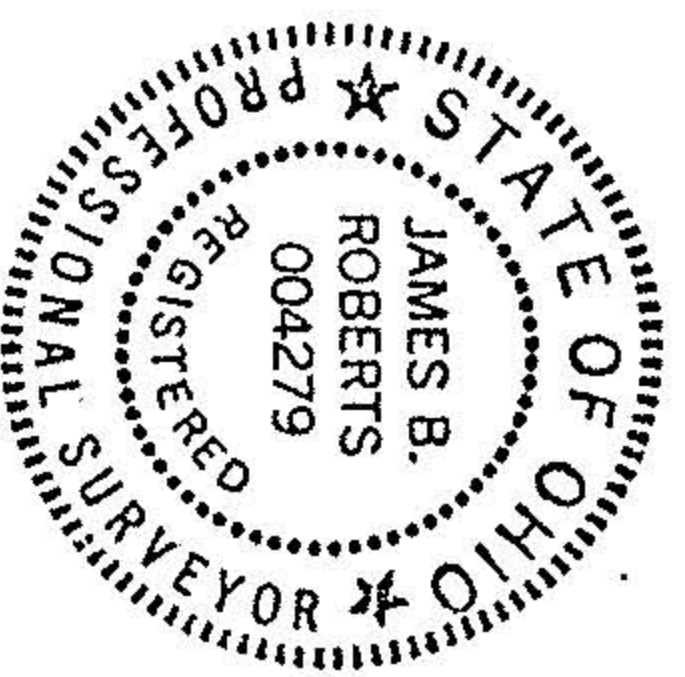

K.E. MCCARTNEY & ASSOCIATES

ENGINEERS - SURVEYORS

ELYRIA, OHIO

OCTOBER, 1989

\* 892786

REF: PPKo. 01-00-064-000-019