

FRED G & MARION GRINGLE
V. 465 P 213

SANORA K STARK
V. 1121 P 742

DAVID TOMSCO
V. 1176 P 192

RAYMOND G & SHIRLEY
A. STERK
V. 1140 P 943

RAYMOND E & LINDA RENAE BORN
V. 1349 P 771

BERNARD N & KAREN L. KAUK
V. 1265 P 674

SETH D & RUTH A.
STEVENS
V. 1208 P 775

BERNARD N & KAREN L. KAUK
V. 1972 P 541

WM. & LUITGARD
BRINGMAN
V. 759 P 315

PARCEL No 3
4.0823 Ac.

PARCEL No 1
2.6976 Ac.

PARCEL No 2
1.2300 Ac.

RUTH J. & RICHARD J. REED
V. 790 P 86
(Rmar.)

DON M. & LINDA D. BETTS
O.R.V. 46 P. 833

MICHAEL KOTORA
V. 774 P 497

GLENN E. SEIBERT
V. 1118 P 606

JOHNNY M. TURNER
V. 1049 P 66



ROAD 60'
CLAUS

#18799

APPROVED
LORAIN CO.
MAP DEPT.

DATE 1-3-90

PAGE 1-00-037-B

BY CAROLYN
FRANUS

VOID
AFTER # 18799

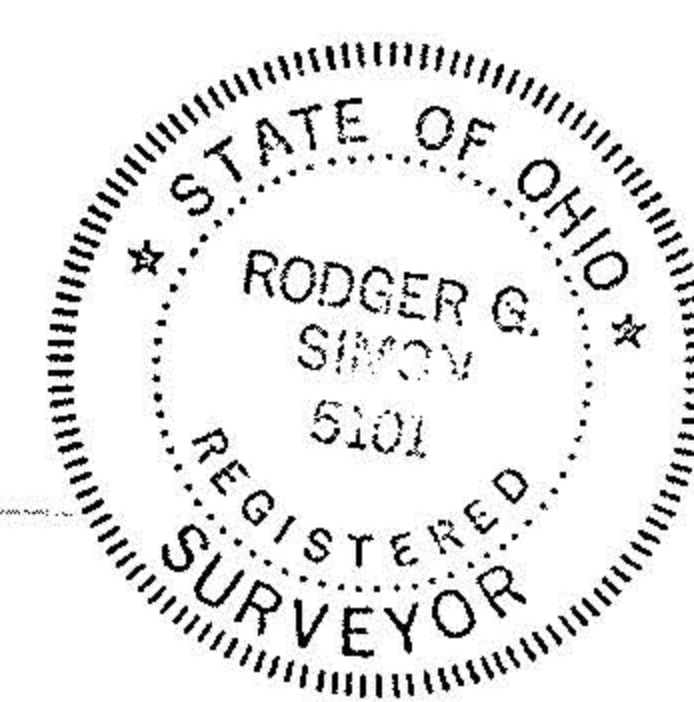

BERNARD & KAREN L. KAUK

PART of O.L. 37
COUNTY of LORAIN
SCALE 1"=50'

BROWNHelm TWP.
STATE of OHIO
DEC., 1988

LAUNDON • SIMON • CAHL & ASSOC.
ENGINEERS SURVEYORS

Job No. 88-1783