

9894

SEP 1 1976

025 = 200 x 234.05
To Split Parcels

JAN 18 1977

9894

APPROVED
LORAIN CO.
MAP DEPT.

DATE 8/27/76

PAGE 7-00-017 B

BY L. W. HALL

VOID AFTER

SEE 7-00-018-D

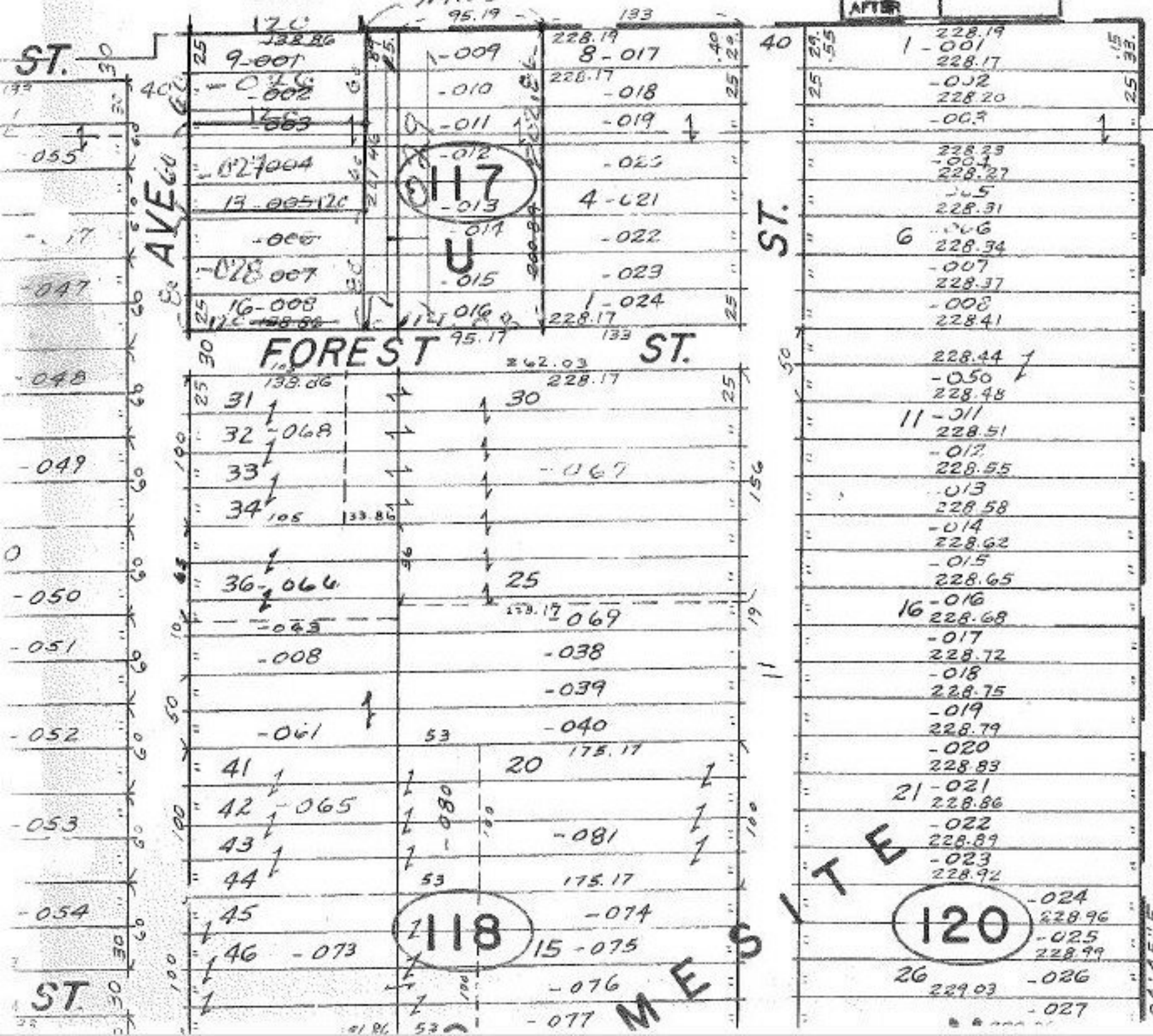

ST. 30
055
047
048
049
050
051
052
053
054
ST. 30

AVE G

FOREST ST.

ST.

MESQUITE ST.

118

120

04' 45" E.