

8919

JUL 10 1975

SEE 11-

-001
28.64

2462.46
<u>343.47</u>
2118.99
<u>534</u>
1584.99
442.86
<u>225</u>
217.86

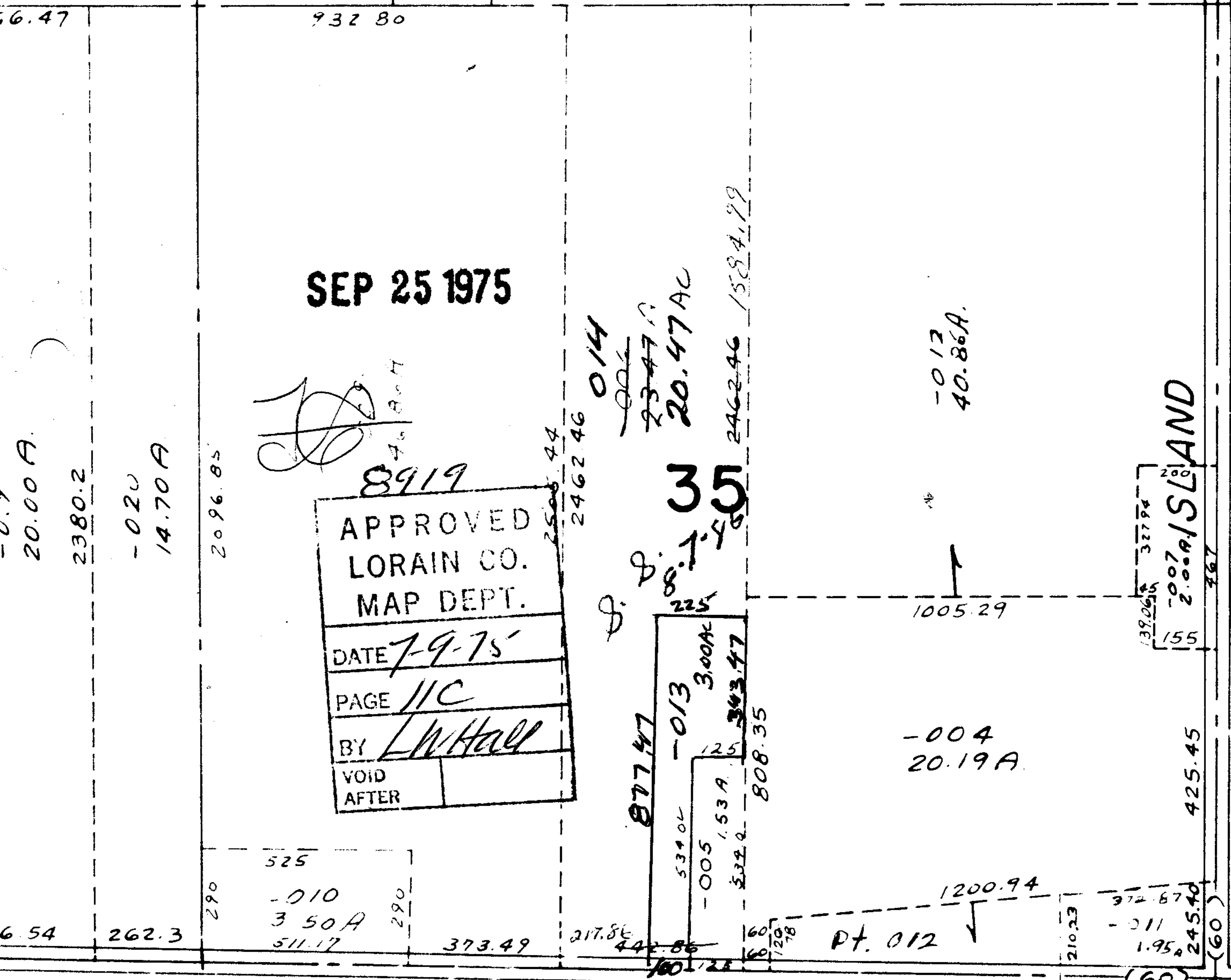

SEP 25 1975

8919

APPROVED
LORAIN CO.
MAP DEPT.
DATE 7-9-75
PAGE 11C
BY LWHall
VOID AFTER

LOTS 31 THRU 35
46 " 50