

SEE 1-L

#8729

MAY 1 1975

8729

APPROVED LORAIN CO. MAP DEPT.	
DATE	4-30-75
PAGE	5-00-095A
BY	LW Hall
VOID AFTER	

7-7 98-9-0

DEC 31 1975

~~036~~ 038
~~4479~~ 43.99 Ac

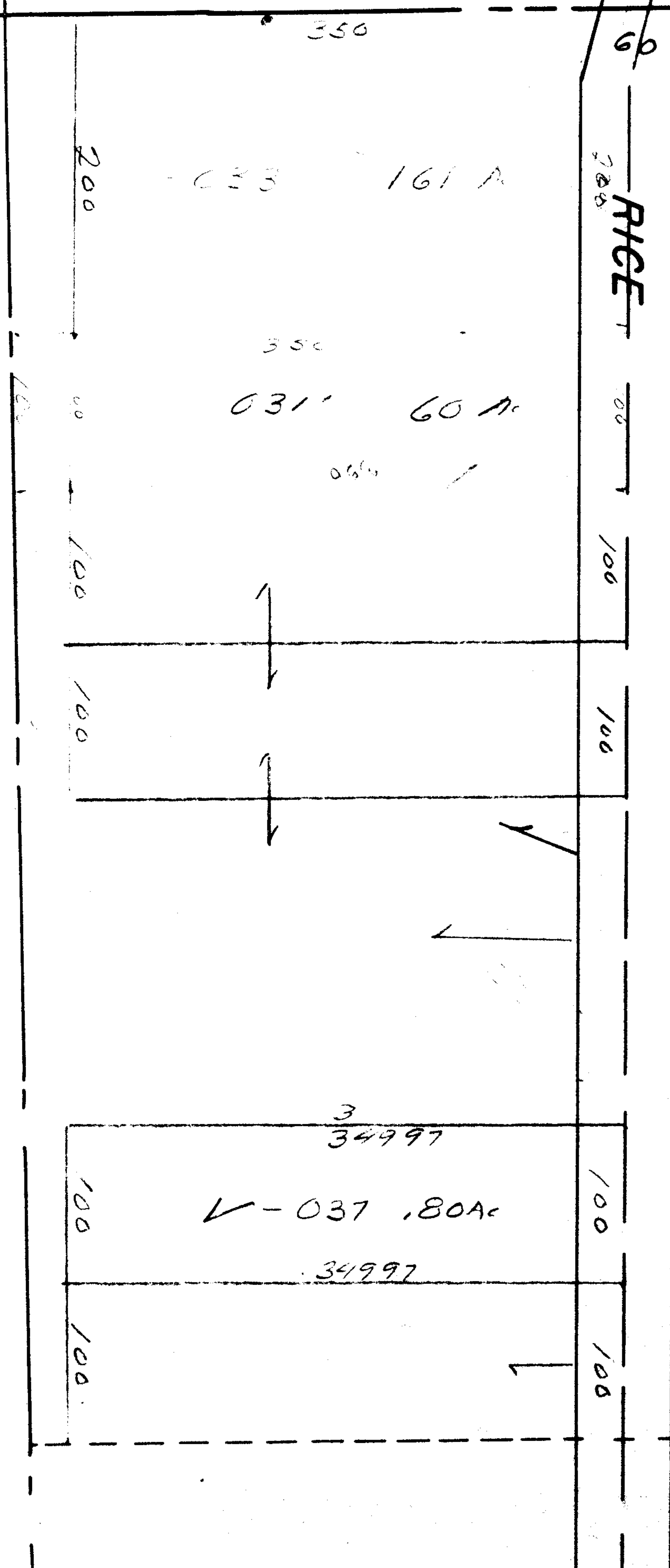

SEE 5-00-0