

See 8679

8570

APPROVED  
LORAIN CO.  
MAP DEPT.

DATE 2-21-75

PAGE 11-00-079A

BY *Hollert*

VOID  
AFTER

-025

~~-026~~

~~001~~

49.44 A.

~~74.68 Ac.~~

75.21 Ac.

FEB 27 1975

*28-171-8*  
*8*  
*8*



R.D.

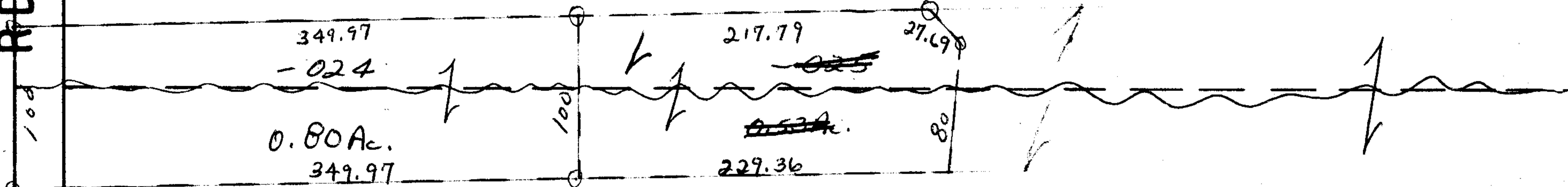

0.80 Ac.  
349.97

229.36

$\frac{76.01}{80}$   
 $\frac{49.44}{76.01}$   
 $\frac{75.21}{74.68}$

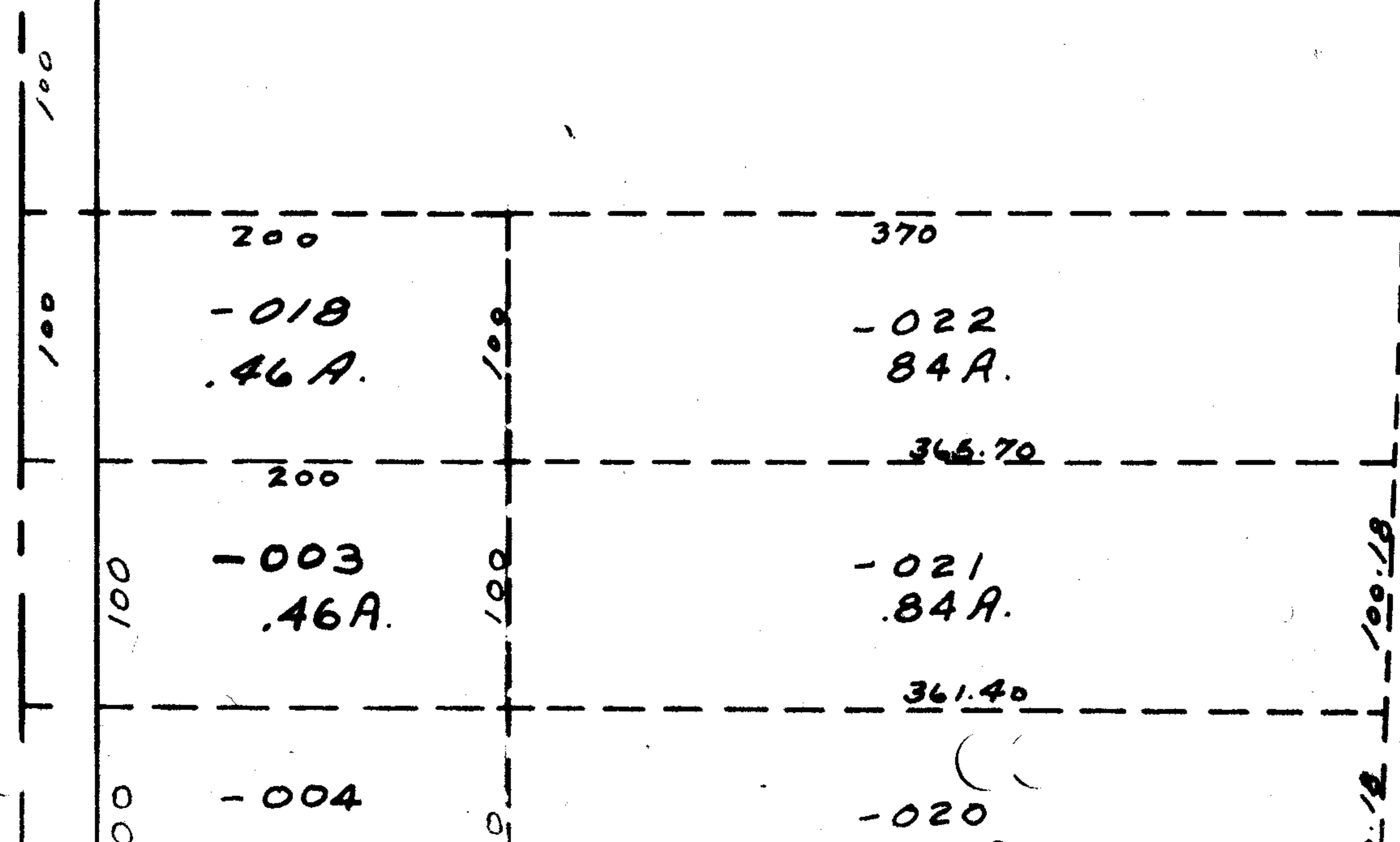

~~49.44~~  
~~80~~  
~~48.64~~

-023

Pt 26.57 A.

~~49.44~~  
~~26.57~~  
~~76.01~~  
~~80~~  
~~75.21~~