

RANGE - RICHFIELD

(602)

CHAMBERLAIN

5.01A

42

40.00A

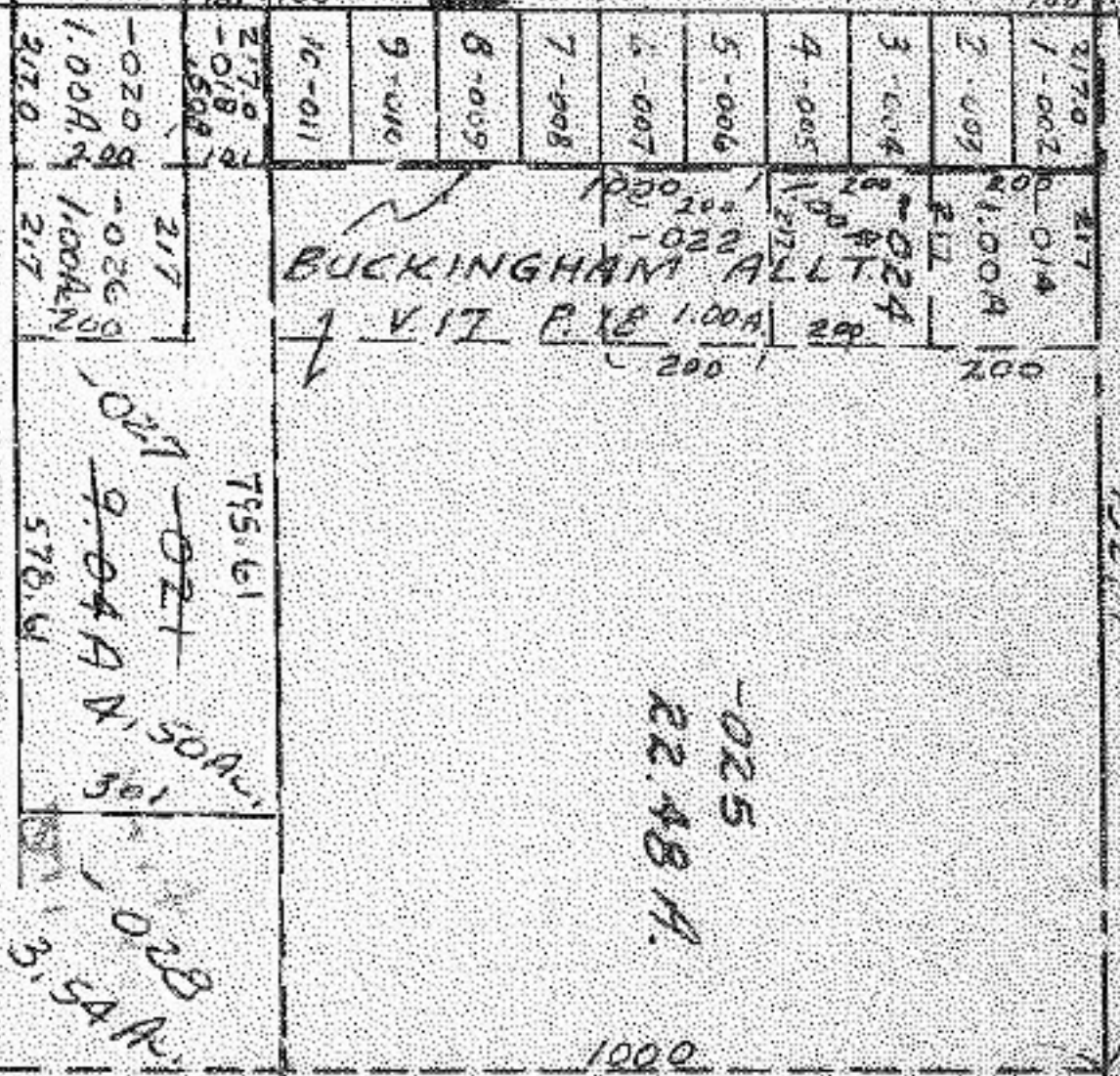

JAN 10 1975

MAY 15 1975

8494

APPROVED.
LORAIN CO.
MAP DEPT.

DATE 1-7-75

PAGE 16-A

BY *[Signature]*

VOID AFTER

8-003
40.00A

41.00A

1329.9

1329.9

1329.9

2673

1000

209

1045

209

209

1329.9

1329.9

209

1045

209

209

1329.9

1329.9

209

1045

209

209

1329.9

1329.9

209

1045

209

209

1329.9

1329.9

209

1045

209

209

1329.9

1329.9

209

1045

209

209

1329.9

1329.9

209

1045

209

209

1329.9

1329.9

209

1045

209

209

1329.9

1329.9

209

1045

209

209

1329.9

1329.9

209

1045

209

209

1329.9

1329.9

209

1045

209

209

1329.9

1329.9

209

1045

209

209

1329.9

1329.9

209

1045

209

209

1329.9

1329.9

209

1045

209

209

1329.9

1329.9

209

1045

209

209

1329.9

1329.9

209

1045

209

209

1329.9

1329.9

209

1045

209

209

1329.9

1329.9

209

1045

209

209

1329.9

1329.9

209

1045

209

209

1329.9

1329.9

209

1045

209

209

1329.9

1329.9

209

1045

209

209

1329.9

1329.9

209

1045

209

209

1329.9

1329.9

209

1045

209

209

1329.9

1329.9

209

1045

209

209

1329.9

1329.9

209

1045

209

209

1329.9

1329.9

209

1045

209

209

1329.9

1329.9

209

1045

209

209

1329.9

1329.9

209

1045

209

209

1329.9

1329.9

209

1045

209

209

1329.9

1329.9

209

1045

209

209

1329.9

1329.9

209

1045

209

209

1329.9

1329.9

209

1045

209

209

1329.9

1329.9

209

1045

209

209

1329.9

1329.9

209

1045

209

209

1329.9

1329.9

209

1045

209

209

1329.9

1329.9

209

1045

209

209

1329.9

1329.9

209

1045

209

209

1329.9

1329.9

209

1045

209

209

1329.9

1329.9

209

1045

209

209

1329.9

1329.9

209

1045

209

209

1329.9

1329.9

209

1045

209

209

1329.9

1329.9

209

1045

209

209

1329.9

1329.9

209

1045

209

209

1329.9

1329.9

209

1045

209

209

1329.9

1329.9

209

1045

209

209

1329.9

1329.9

209

1045

209

209

1329.9

1329.9

209

1045

209

209

1329.9

1329.9

209

1045

209

209

1329.9

1329.9

209

1045

209

209

1329.9

1329.9