

8463

DEC 27 1974

101

Z

3-043  
5-16A

Z

~~0.58~~ 4.29 AC  
-0.60  
4.42 AC

2536

7-044  
2-58A

W

2628

6-045  
2-57A

W

2720

5-046  
2-59A

W

2812

4-047  
2-59A

W

2904

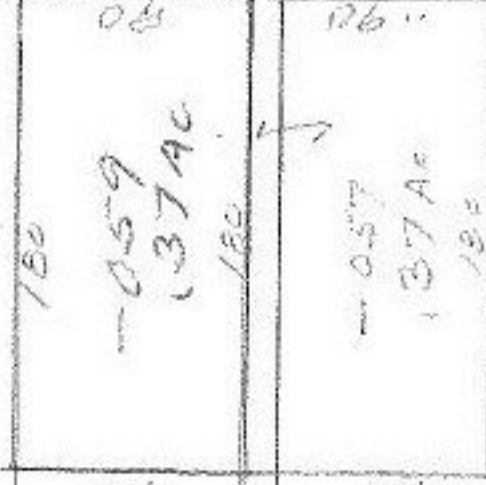

8463

APPROVED
LORAIN CO.
MAP DEPT.
DATE 12-13-74
PAGE 07-00-007 C
BY <i>L. McHale</i>
VOID AFTER



MAY 19 1975

JUL 1 1975

3 THERESA

24 235  
28 16  
-001  
157 59

-002  
127 68

-003  
37 47

-004  
27 26

19 2705

-005  
26 84

-006  
26 53

-007  
25 42

26 2

14-008  
26

119

25 57  
-009

25 36

9 24 02  
24 04

-012  
24 72

-013  
24 20

-014  
24 2

-015  
24 0

4 23 86

-023  
123 67

23 46

124

FRANCES

23 22 0  
22 28

22 07

-004  
31 86

18 005

13 65

124