

~~OCT~~ 11 1974
8346
1/2

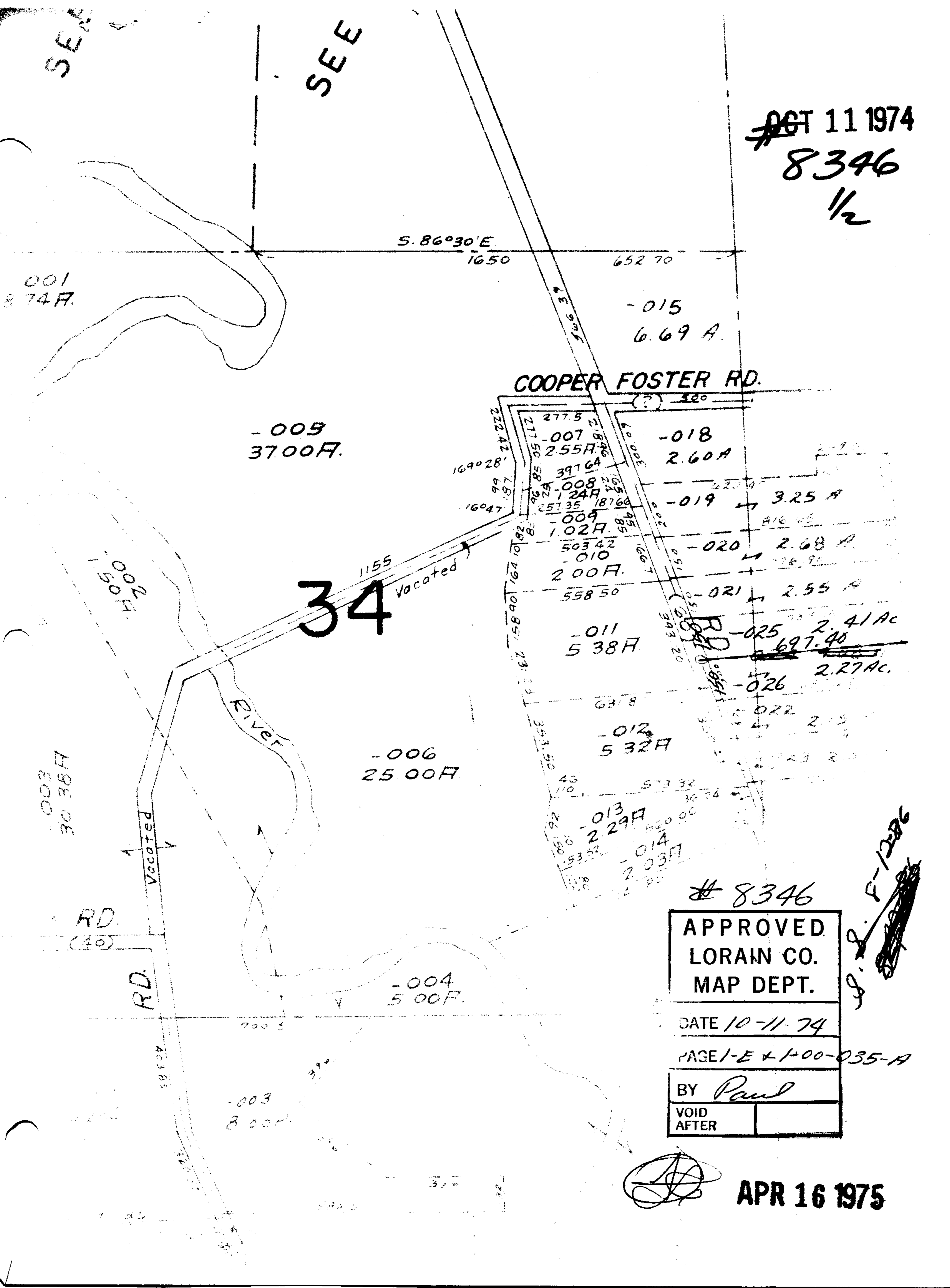

34

-009
37.00 F.

-015
6.69 A.

COOPER FOSTER RD.

-018
2.60 A

-019
3.25 A

-020
2.68 A

-021
2.55 A

-025
2.41 AC
697.40

-026
2.27 AC.

-022
2.12

-012
5.32 F.

-013
2.29 F.

-014
2.03 F.

-006
25.00 F.

-004
5.00 F.

-003
8.00 F.

001
8.74 F.

002
1.50 F.

003
30.38 F.

8346

APPROVED. LORAIN CO. MAP DEPT.	
DATE 10-11-74	
PAGE 1-E + 1-00-035-A	
BY Paul	
VOID AFTER	

J. F. 1206

APR 16 1975