

*Handwritten scribble*

- 004  
43.00 FT.

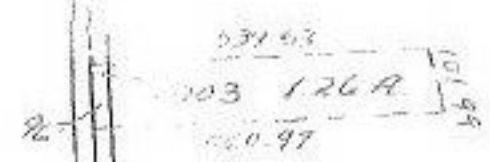

37  
 - 008  
~~- 006~~  
~~23.58 FT.~~  
 92.20 Ac.

8101

7-31-816 L.L.

APPROVED  
 LORAIN CO.  
 MAP DEPT.  
 DATE 7-3-74  
 PAGE 14-C  
 BY *[Signature]*  
 VOID AFTER 8101

AUG 9 1974

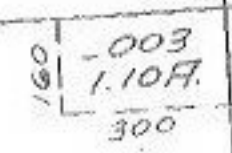
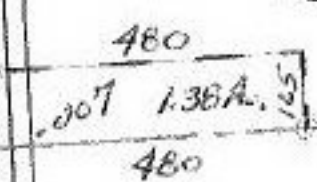

- 001  
13.33 FT.

- 002  
6.67 FT.

- 003  
30.00 FT.

*Handwritten scribbles*

*Handwritten scribble*

*Handwritten scribble*

*Handwritten scribble*

1814.52

107  
10.0 A.

3.04