

7968

SEE 10-G

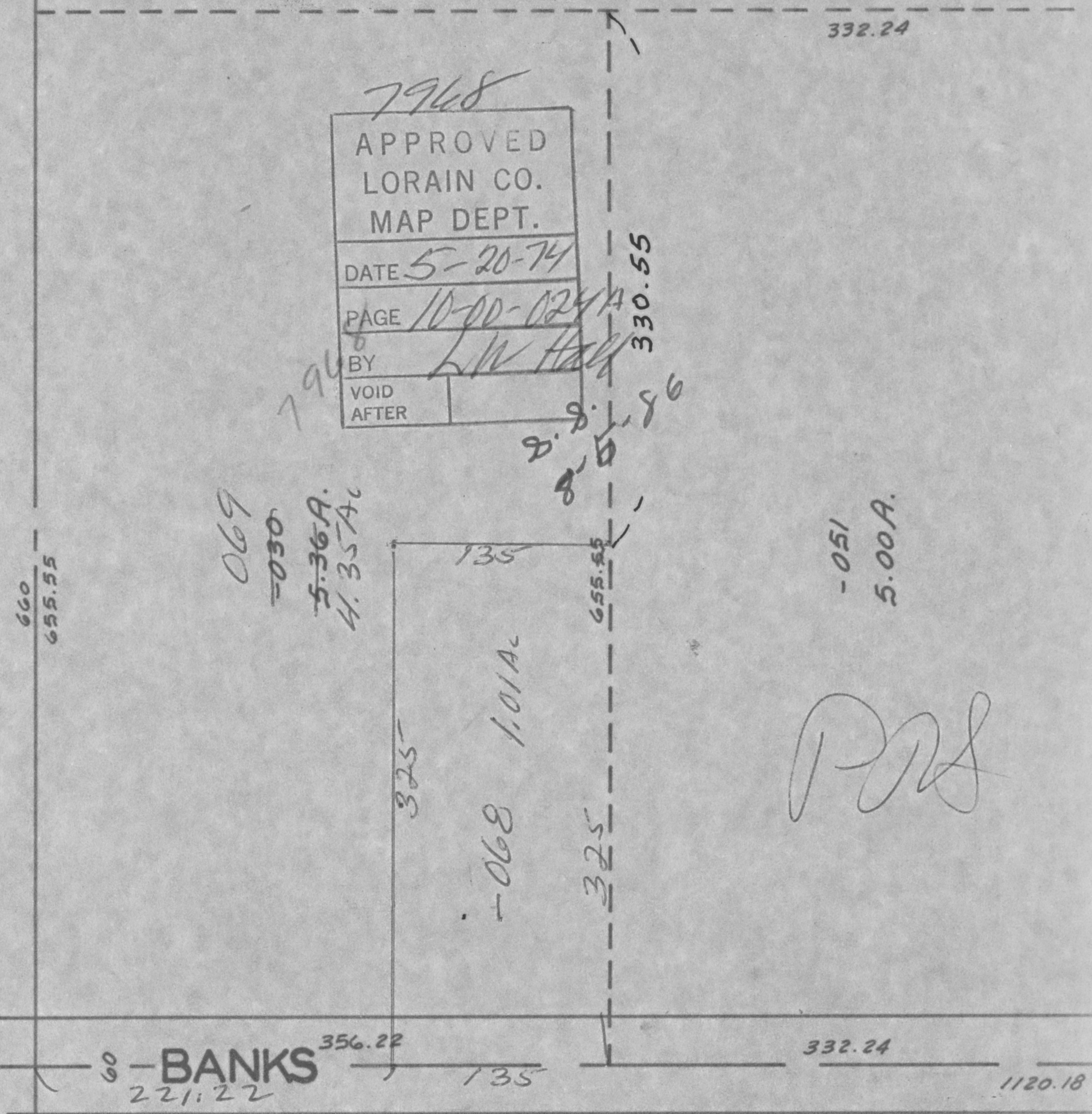

7968

APPROVED
LORAIN CO.
MAP DEPT.
DATE 5-20-74
PAGE 10-00-024A
BY L.W. Hall
VOID AFTER

069
 -030
 5.36A.
 4.35A.

-068 1.01A.

-051
 5.00A.

PS

9 - BANKS 356.22
 221.22

1120.18