

APPROVED  
LORAIN CO.  
MAP DEPT.  
DATE 2-25-74  
PAGE 6-39  
BY Paul  
VOID AFTER

**OK**

195 2  
23 5/10  
43 1/2

V 23 GALAXY  
Pt. 06-24-044-900-002

Pt. 2.75A

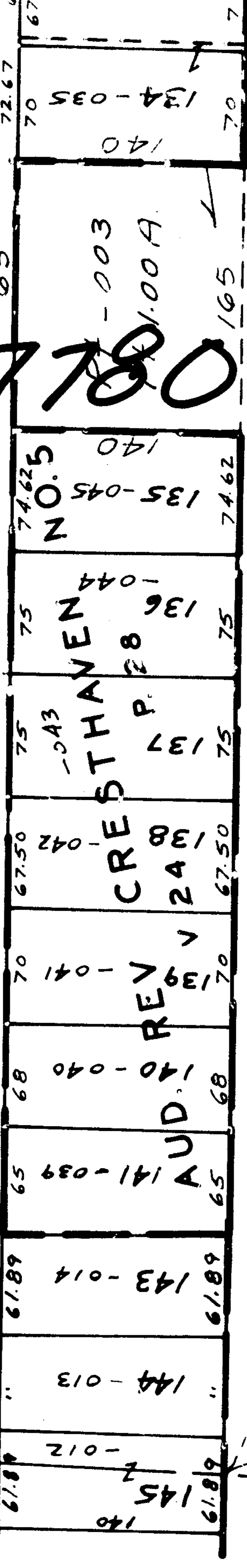

**44**

1593.24

56.15