

3643.20

-004
80.00 A

3633.96

||

T

-005
87.21 A

R

3622.74

OK

1492
666
8.26

-004
35.25 A

GORE - ORPHANAGE -005 2.00 A
645.40
645.40

7475¹²

APPROVED
LORAIN CO.
MAP DEPT.
DATE 10-19-73
PAGE 8-E
BY *F. Haller*
VOID AFTER

7-30-86 h.w. -011
10.90 A.

-016
77.69 A.

957.66

BATES

(60)

534
-006
4.00 A
534
326.29
100
-0086
100.58 0

280.50
320.
7.22 A
1320

89°21'

48.11

SEE

138.29
380.29

-028
A 8.26 Ac.

625.

300
-021
2.62 A
380

106.86

437.93

434

323

330
264
200.14
330

1461.4

800.12

-027

224 6.66 Ac

871.37

1170

669

5.46 A

390.69

-023

323

1480.50

7475

89°05'

735.02

90.

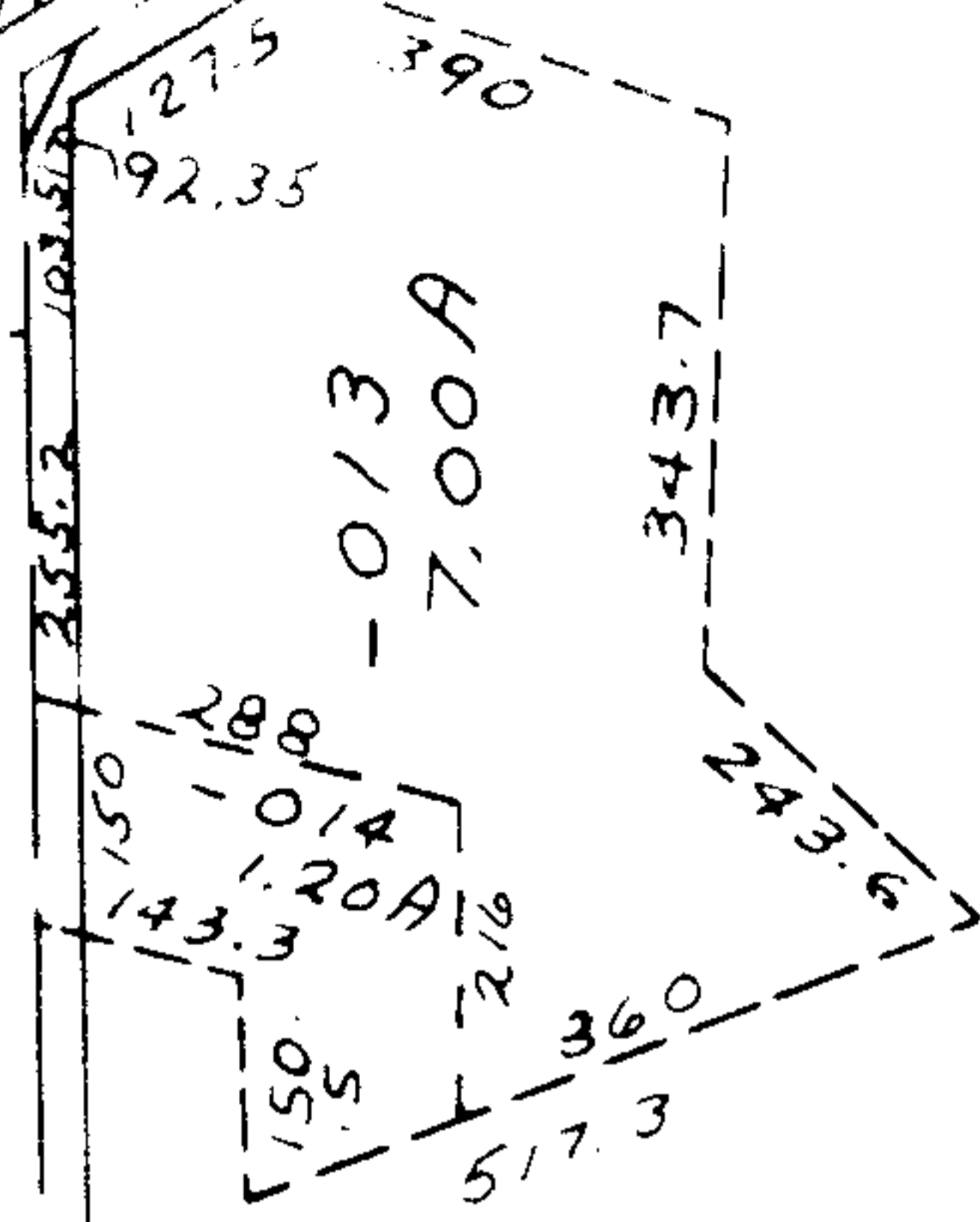

PRJ