

7023

101

P.R.S.

2363
1735.60

Change
No. & Acre

-018
Pt. -003
Pt. 15.66A.
15.60Ac.

APPROVED
LORAIN CO.
MAP DEPT.
DATE 5-23-23
5-00-005-A+B
BY *[Signature]*

7998.98-6

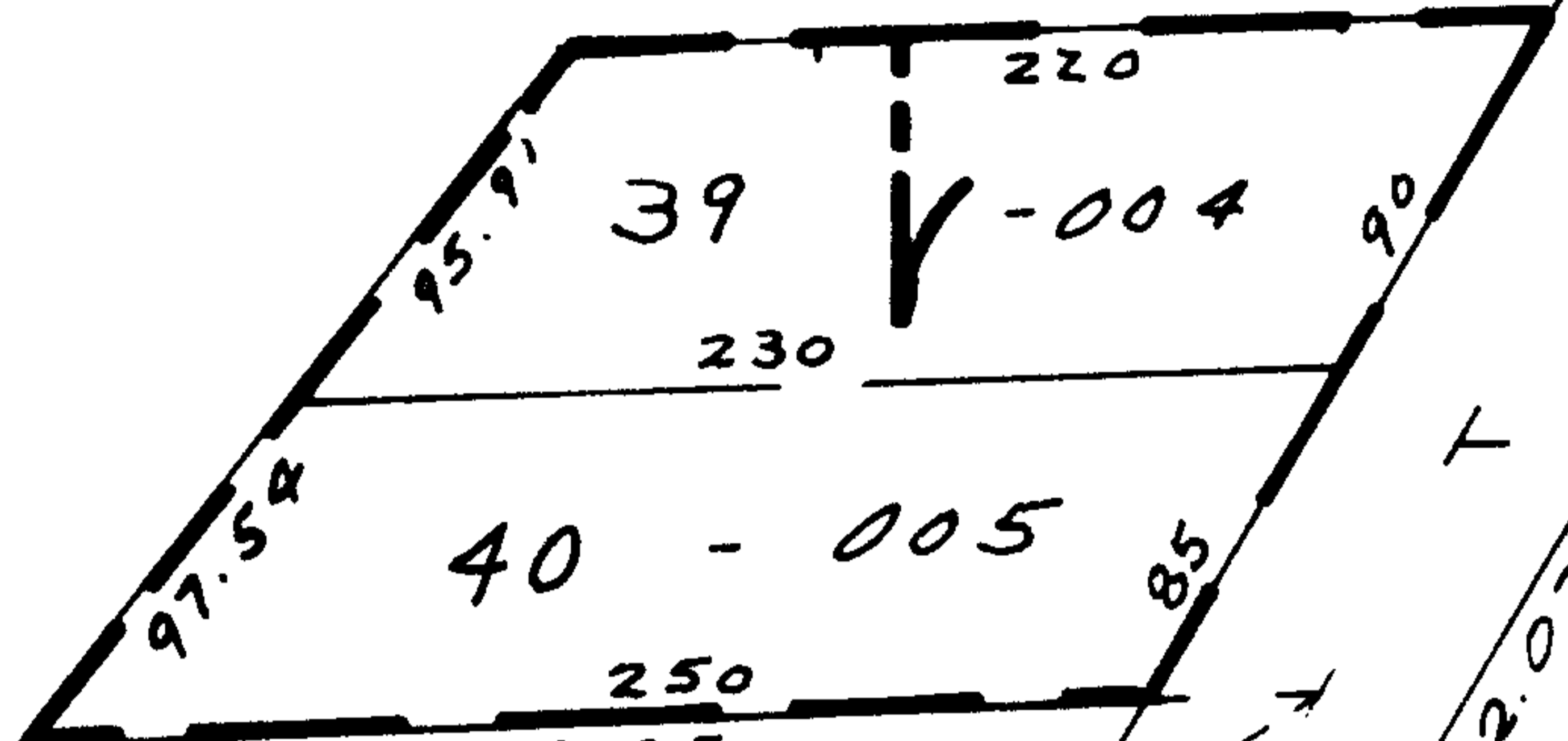

-006
63A.

234.77
-007
.50A. B *Forward*

233.26
-017 121.99
112.25 106A. 47.26

200
-003
46A.

200
-004
41A.

-008
2.24 A.

501.17 48
339.62

22/5.38

468

132.07

30
-008
.04A

-00
2.0

350.2

239.17

238.72

764.75

175
434.5

100

100

120

100

75

25

100

155

5.88

1.43

155