

001  
1.00 A.

-008  
19.57 A.

6891

-002  
7.00 A.

-001  
38.95 A.

6891

**APPROVED**  
**LORAIN CO.**  
**MAP DEPT.**  
**DATE 4-11-73**  
 19C  
**BY L.V. Hall**

34

~~002~~  
~~67.85 A.~~      -014  
6321

C-M-OK FOSTER

P.R.S.

-004  
31.91 A.

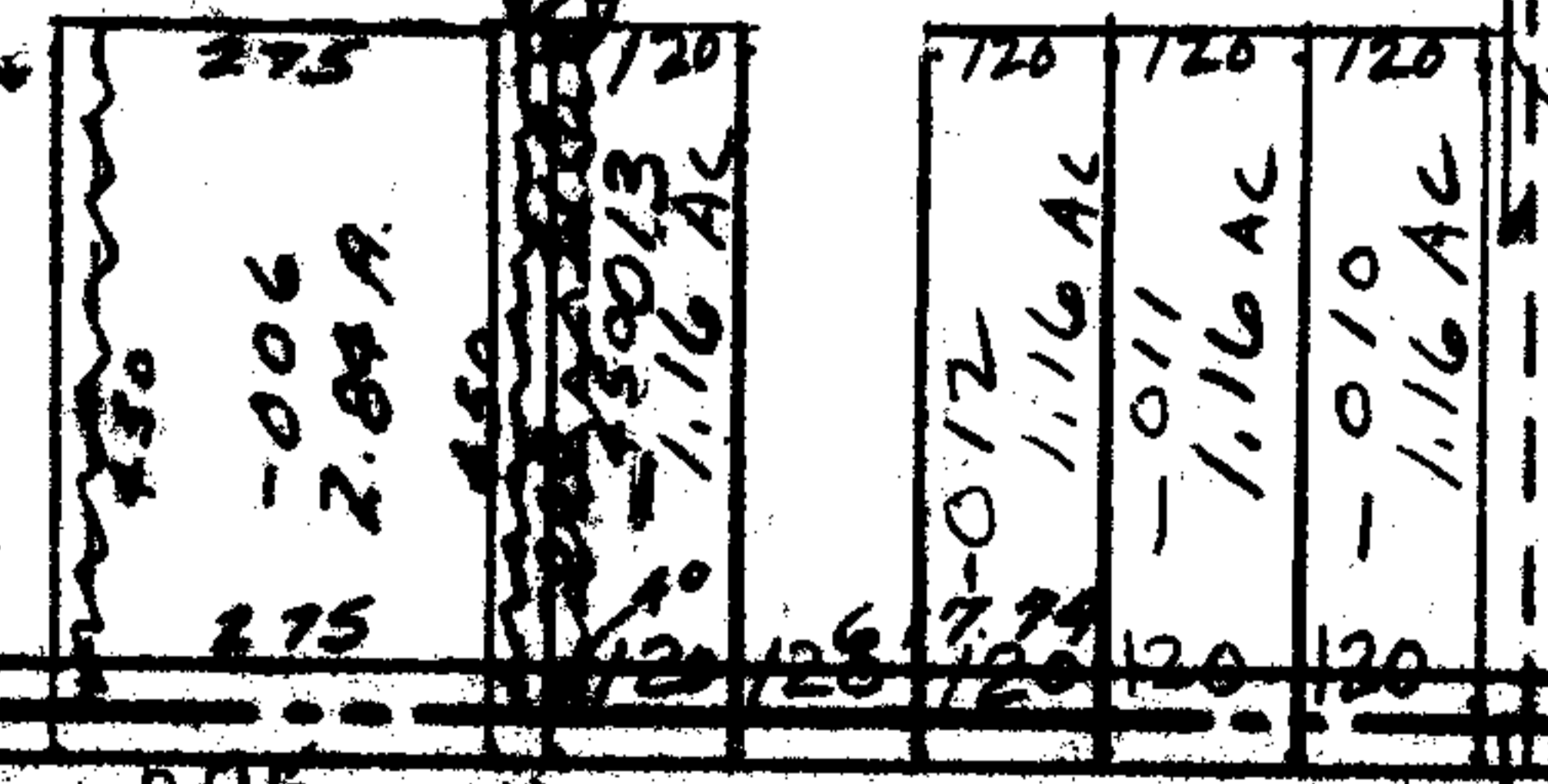
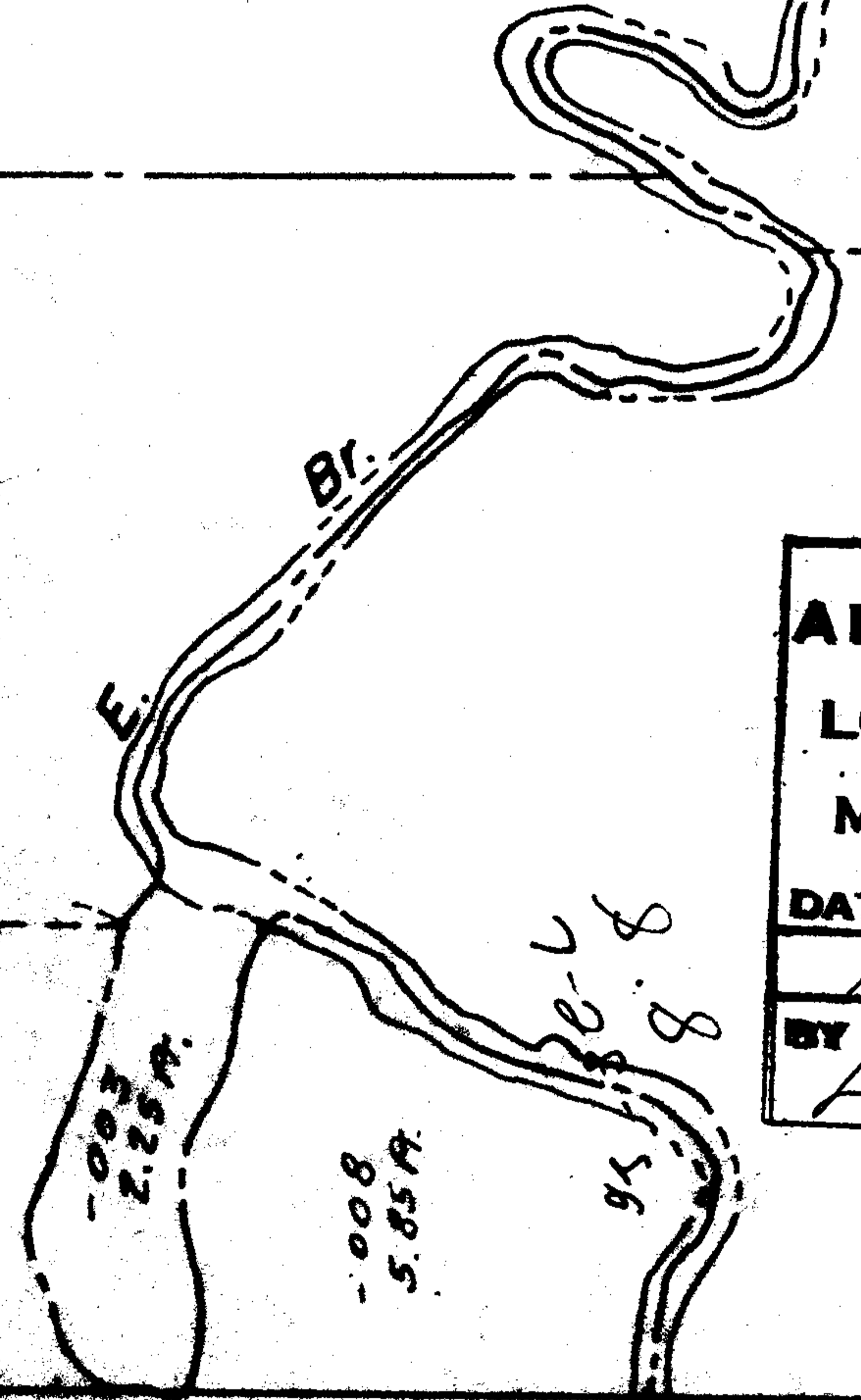

306.24  
-005  
1.05 A.

LORAIN COUNTY SUB D.V. 88 Pg. 251  
D.V. 87 Pg. 434

4 LOTS 9 THRU 12, 34, 35  
 5 " 5 " 8, 8 WLY. PT. LOTS 37, 38, 39  
 6 " 105 " 108 & " " " I THRU 4

6891