

6317



77.9 R.D. 124.09

1081.19

Pt 029
Pt 500 A

[Handwritten signature]

Pt -028

Pt. 22.12 A.

Pt 030 17.12 AC

Pt

102°34'

153.50

7-1886 L.L.

6317
APPROVED

LORAIN CO.

MAP DEPT.

DATE 9-14-72

07-00-043C & 7A

BY L.W. Hall

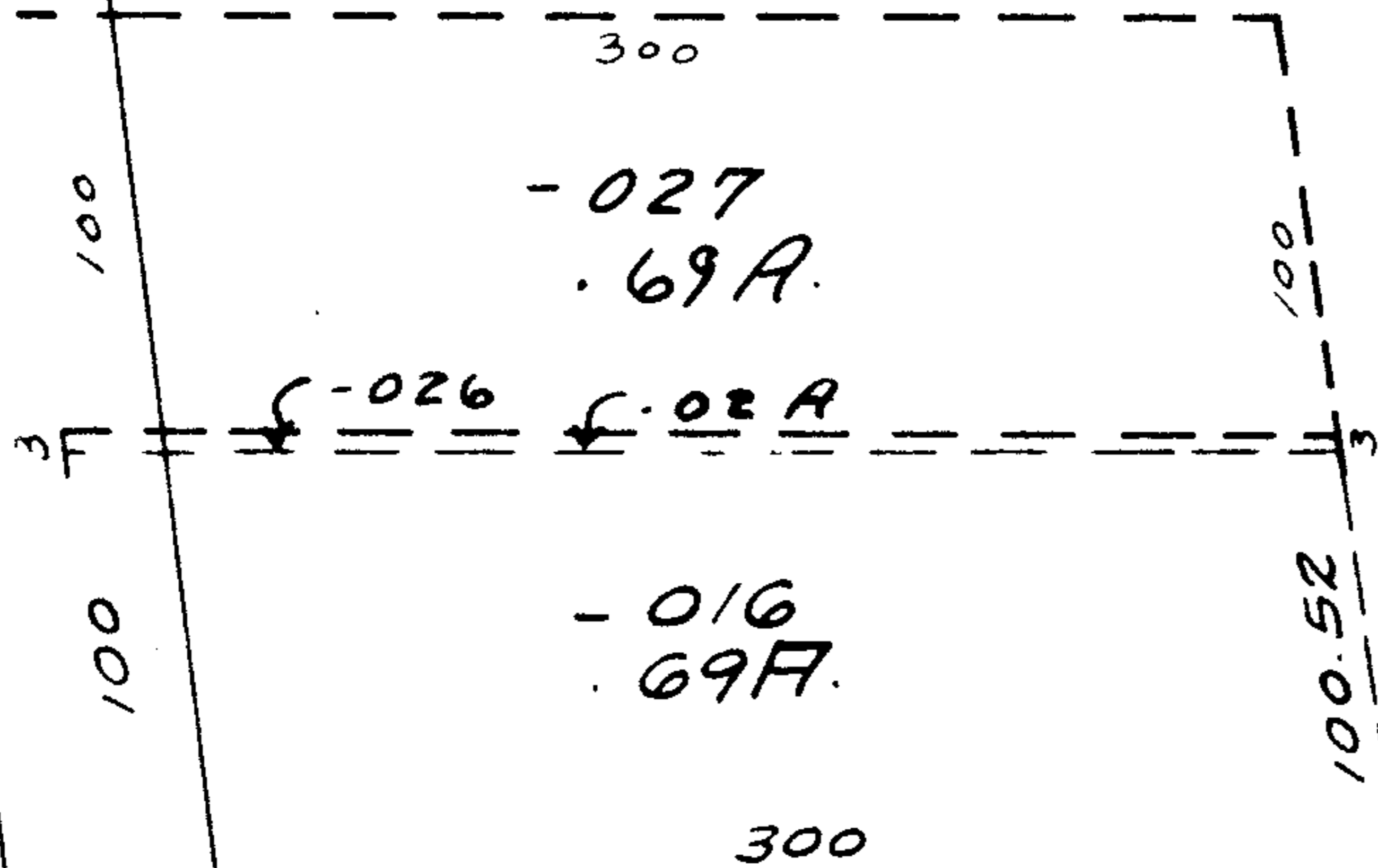

752.66

105

Pt. -023

Pt. 1.56 A.

CASE 77.75

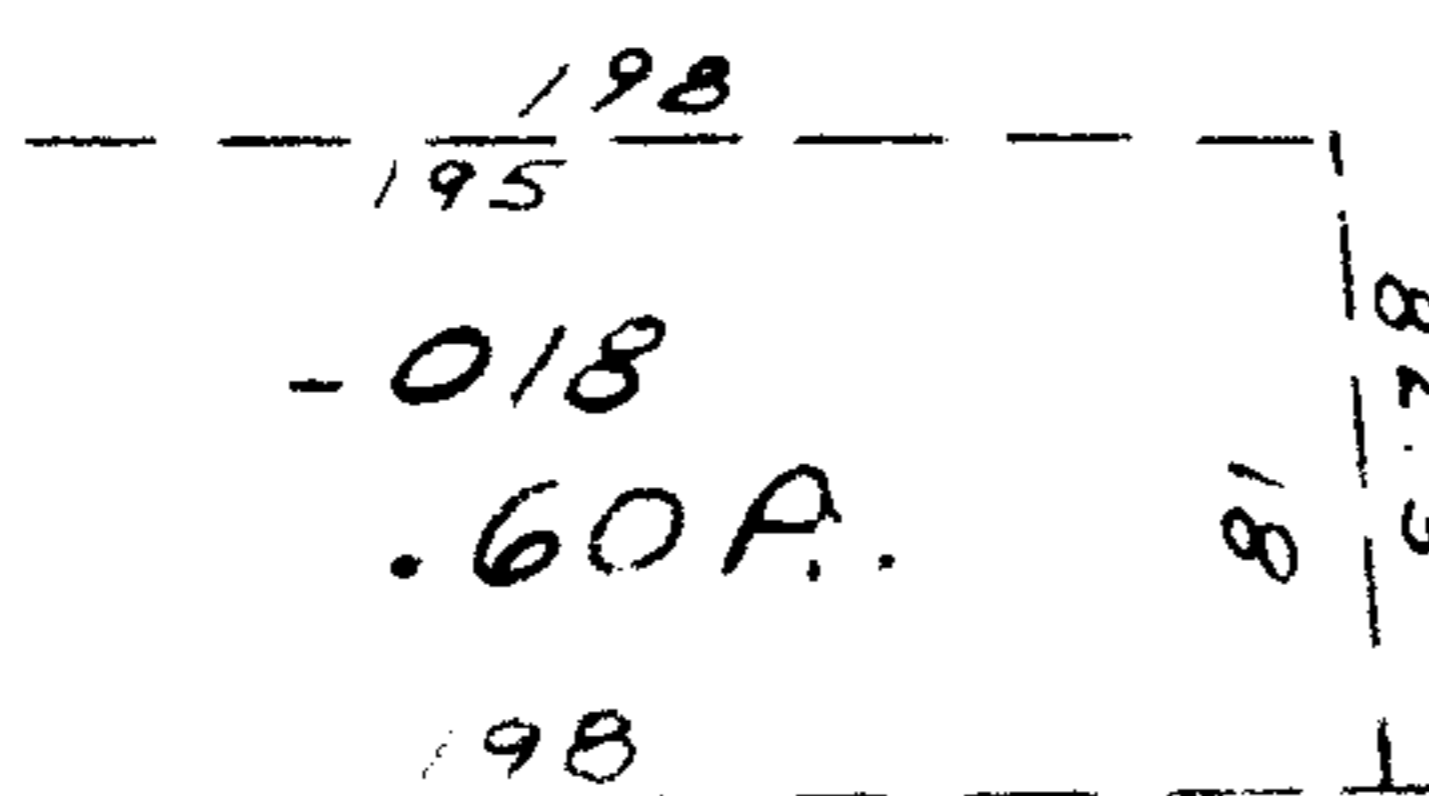

Pt. -022

Pt. 12.69 A.

7-00-043-C

3346.33

34°