

ELYRIA - TWINSBURG

5541

RD

RD

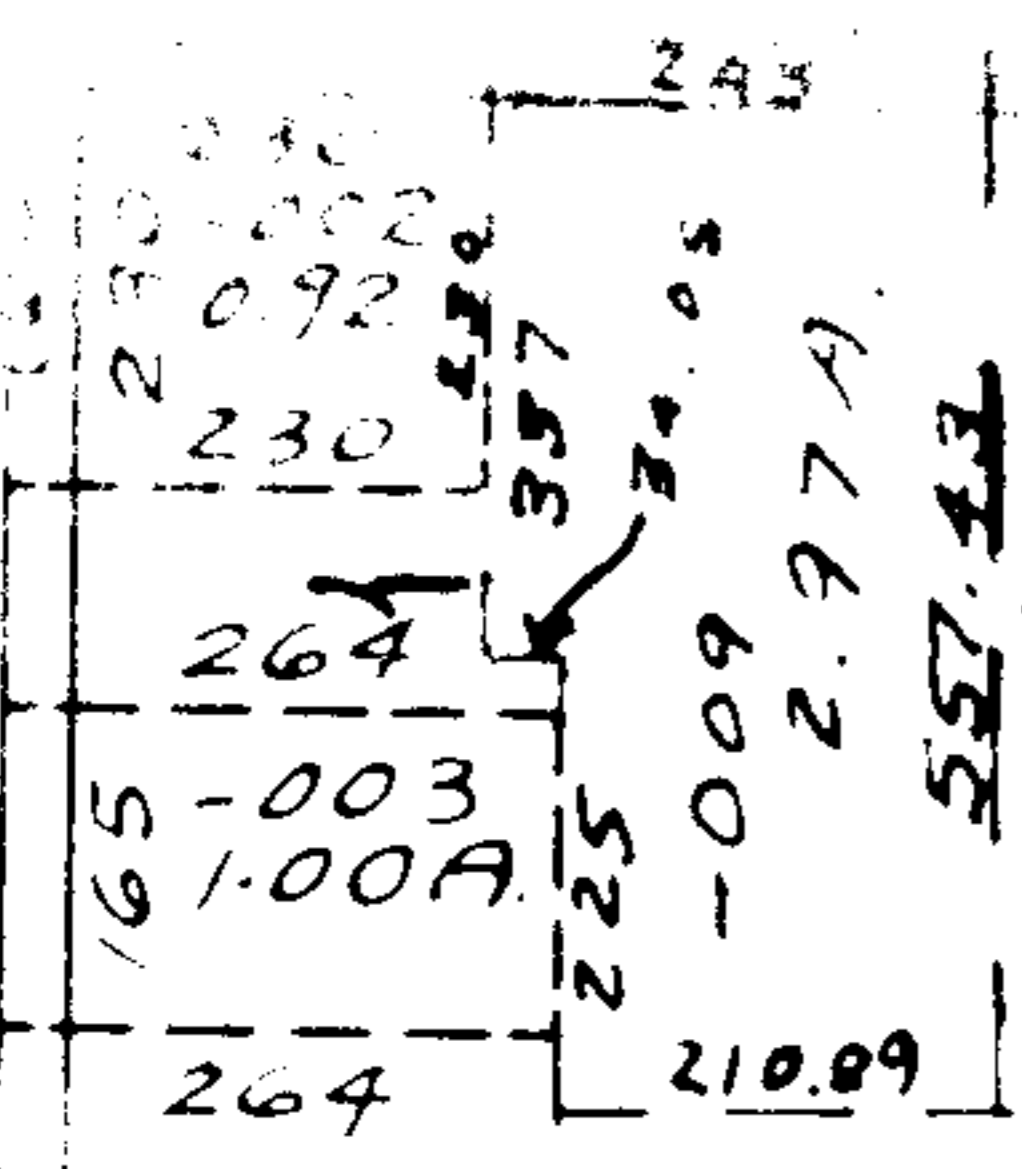

-010
145.11A

25

PT 4991A
St.

PT 11-00-006-500-001
C. B

C. 1759.29
-004
11.71A

-012
43.20A

568

3.12A

363-006
-011 0.57A
1.56A
200
57A
200

1435.5

-020
852.51-60A

-011 1446 5.11A

857.37 50.80 588.63
-006 1.66A
588.63

MAR 1 7 1972

APPROVED
LORAIN CO.
MAP DEPT.

-001
38.46A
DATE 1/10/72
LH

BY
R. J. Kelling

DON FITZ

-016
29.30A



1013.35

2017.47

174.30

1095.35

25.96

50.80

50.80