

-025 ✓
68.28A

5301 SEP

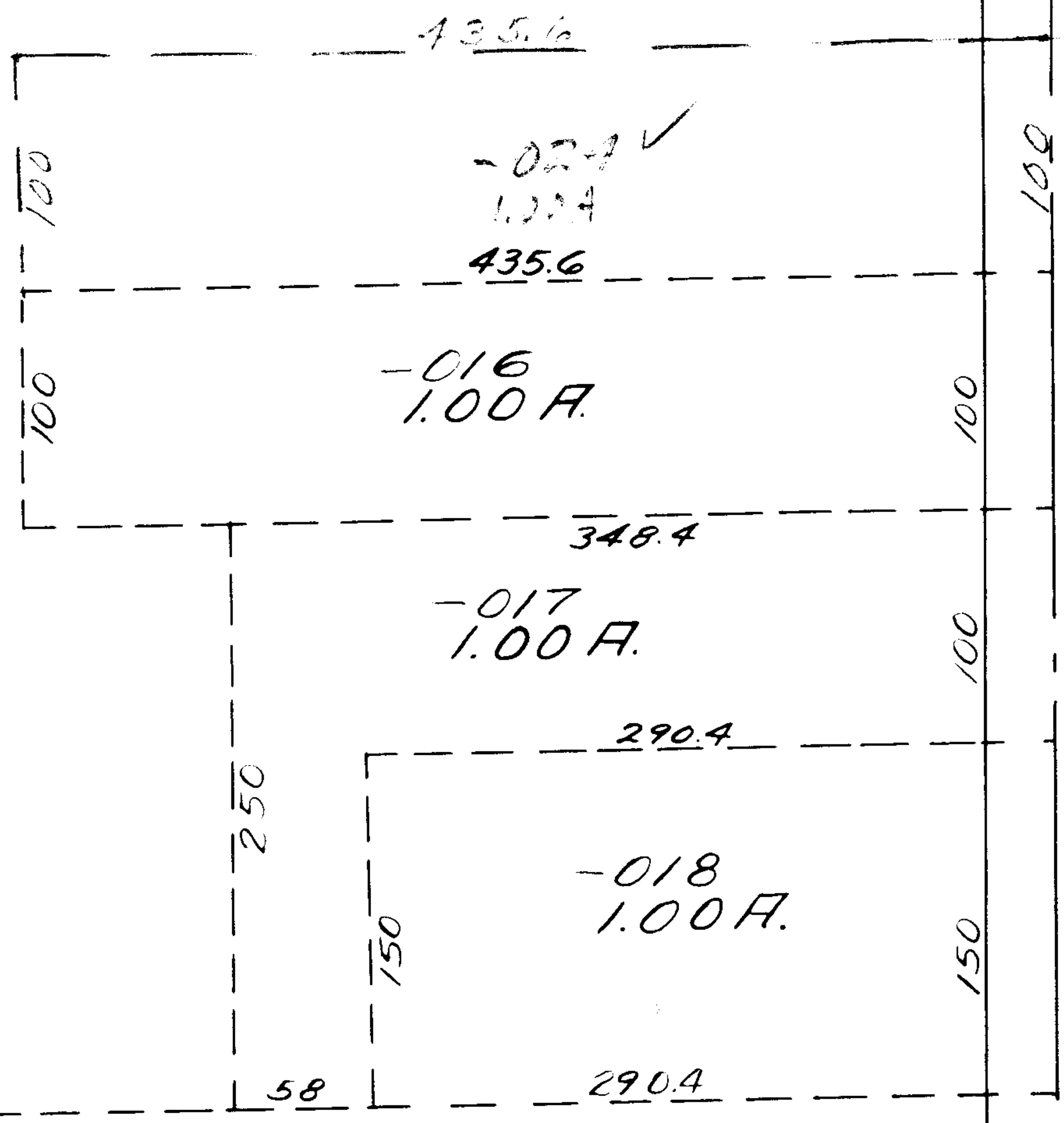

-019
5.00 A.

7-22-86
S.S.

NOV 23 ENT'D

5301

APPROVED
LORAIN CO.
MAP DEPT.
DATE 10/12/71
11-00-016-B
BY R. J. Kelling

Pt 11-00-005-00L
Pt. 42 27 A.