

4473

3470.94

4564.56

APPROVED

LORAIN CO.

MAP DEPT.

DATE 11/17/90

18-A

BY

R. Kelling

DEC 2 1990

8-86
8-18

-002
73.50F.

-003
.50F.

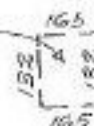

-004
1.00F.

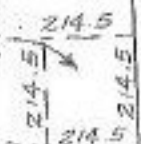

4356

42

-006
-005
142.00F.
132.91

-010
38.00F.



175

767.34

-007
3.07

RD

(60)

-002
.25F.



444.46

943.14

