

-037
Pt. -026
Pt. ~~60.00~~A.
58.92

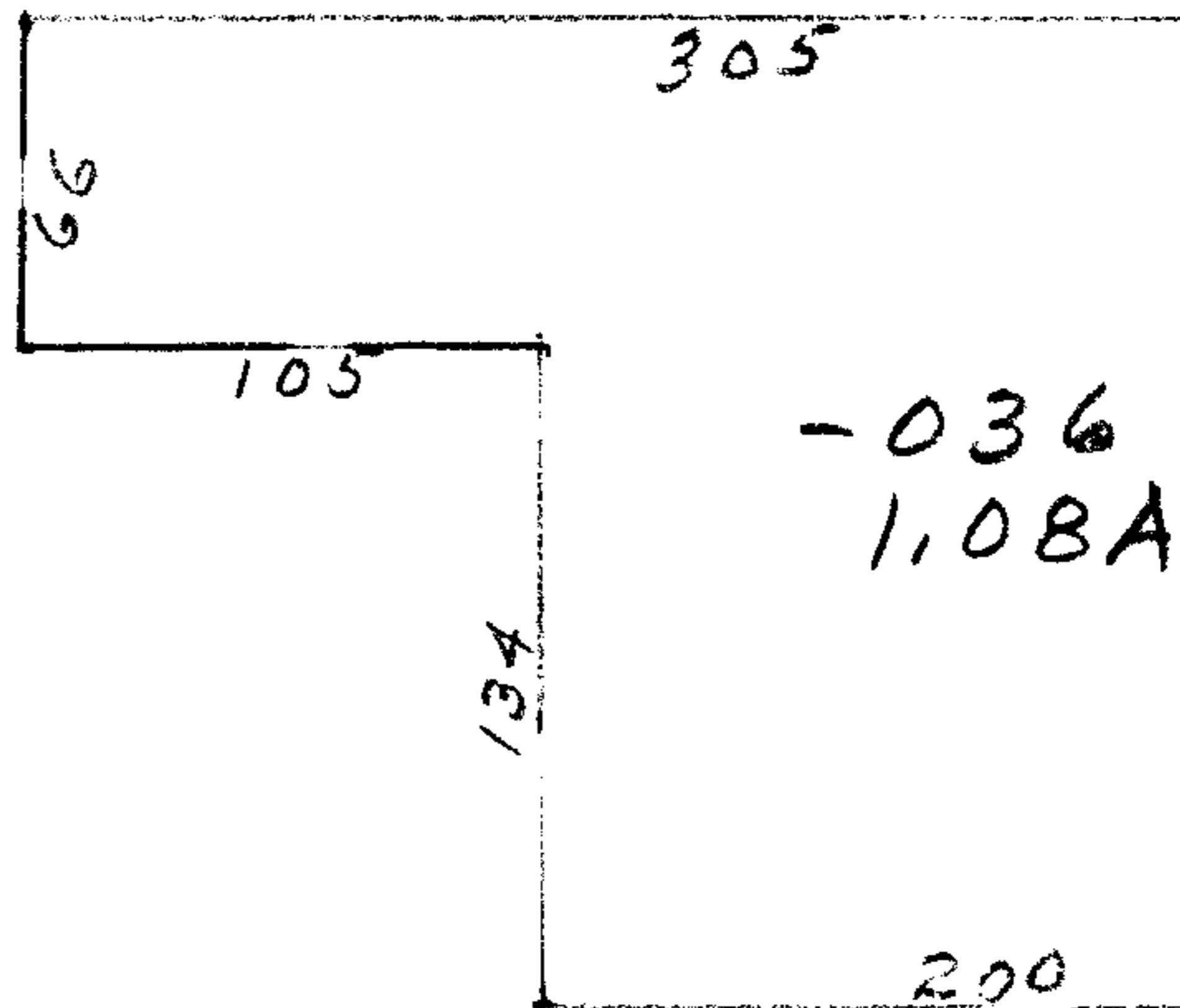

APPROVED
LORAIN CO.
MAP DEPT.
DATE 3/19/69
Pg 12-00-080-A+B
BY
R.V. Kelling

P.S.
7-25-68

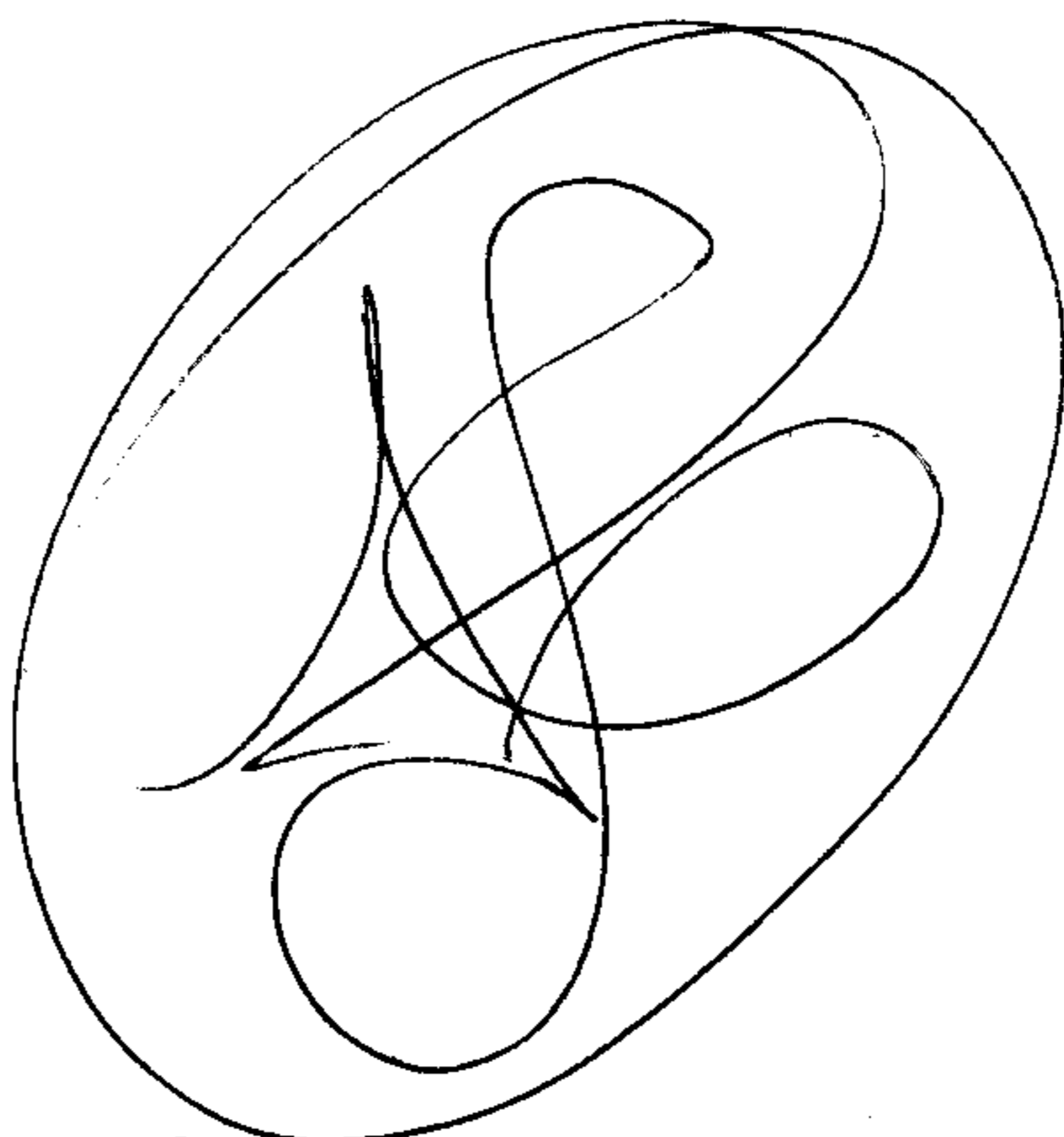

2545

JUN 16 1969

S. Line of L. 80

STATION



60