

PARENT PARCEL: 03-00-042-119-033

CHILD PARCEL: 03-00-042-119-086 & -087

STARTING POINT: CL OF ROBERTS ST. & CL OF FOREST LAWN

NO. 22669

1"=100'

FOREST LAWN 60'

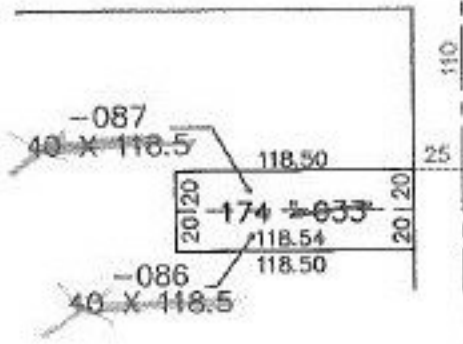

ROBERTS ST. 50'



1"=50'

FOREST LAWN 60'

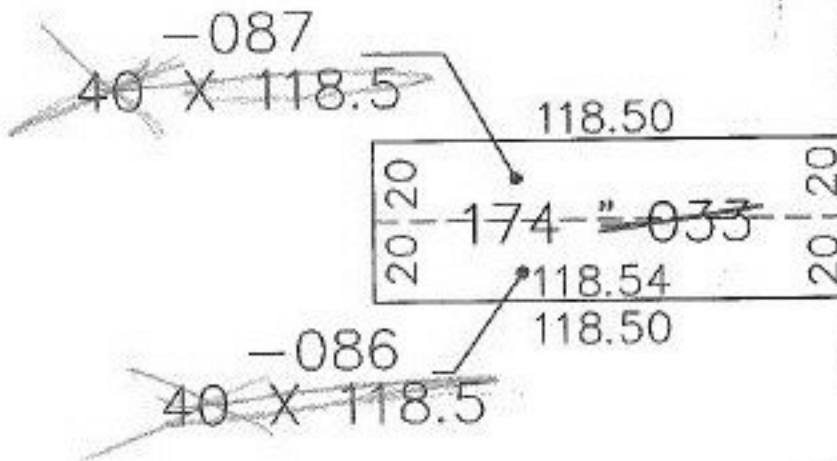

ROBERTS ST. 50'

4-29-99

SPLITS/DEEDS PROCESSED

LORAIN COUNTY TAX MAP DEPARTMENT
226 MIDDLE AVE. ELYRIA, OHIO

SURVEYED BY: JOHN POZYWAK

CLOSURE: 0.00 : 10.000

MAP PAGE(S): 03-00-042-8

APPROVED BY: IJS DATE: 10/14/98

SCALE: 1"= 100' PRIOR INSTRUMENT: 980544585