

PARENT PARCEL: 02-01-006-131
 CHILD PARCEL: XX-XX-XXX-XXX-XXX
 STARTING POINT: ALLEY (16' WIDE), WEST OF HAMILTON AVE., FROM THE SOUTHLINE OF WEST 16TH ST.

NO. 22590-V



ALLEY VACATION

02-01-006-131

ORDINANCE NO. 229-97

VACATE ALLEY (16' WIDE) WEST OF HAMILTON AVE. FROM
 THE SOUTHLINE OF W. 16TH ST TO THE NORTHLINE OF W. 17TH ST.

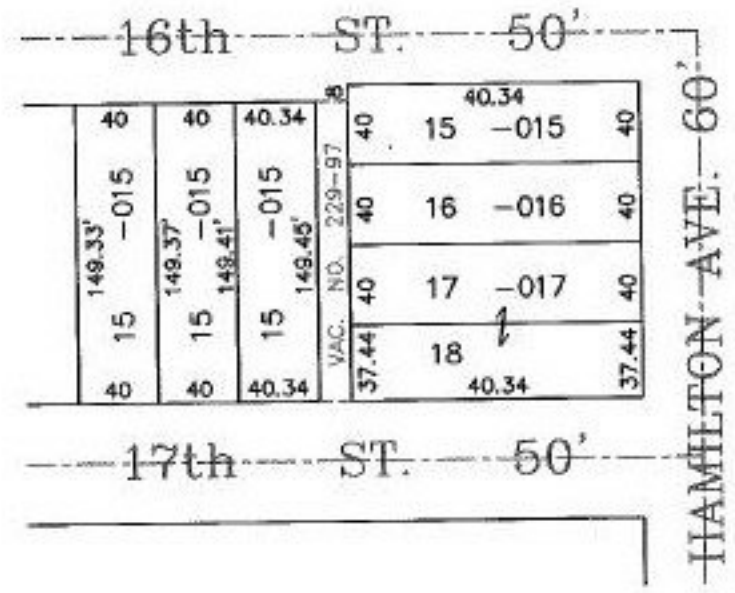

TJ
2-25-99

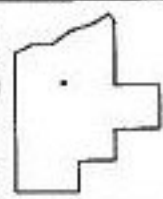

SPLITS/DEEDS PROCESSED
 LORAIN COUNTY TAX MAP DEPARTMENT
 226 MIDDLE AVE. ELYRIA, OHIO

SURVEYED BY: ORD. NO. 229-97
 CLOSURE: LORAIN CITY
 MAP PAGE(S): 02-01-006-C
 APPROVED BY: TJS DATE: 07/15/98
 SCALE: 1" = 100' PRIOR INSTRUMENT: _____